

Component Procedures: Fuel Rail

Table of Contents

1. Parts and Labor (itype_189)
2. Components (itype_392)
3. Components (itype_32)
4. Procedures (itype_376)
5. Technician Safety Information (itype_15)
6. Mechanical (including Torque) (itype_28)

Component Procedures: Fuel Rail

Parts and Labor (itype_189)

Parts

Qualifier	Part #	Name	Price	Note
Fuel Rail	53013017AB	Fuel Rail	0.00	Order By Description.

Labor

Operation	Qualifier Path	Skill	Std Hrs	Wty Hrs
Replace	Fuel Rail, R&R	B	0.6	0.5

Components (itype_392)

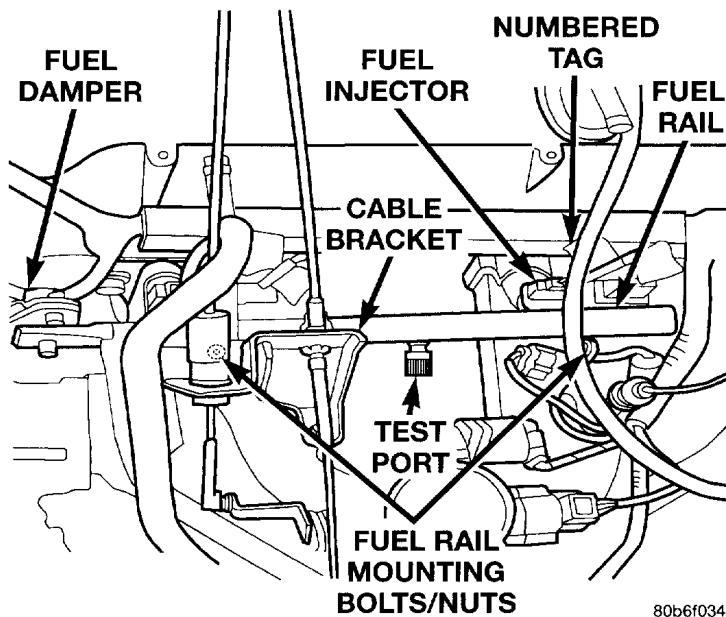

80b6f034

Components (itype_32)

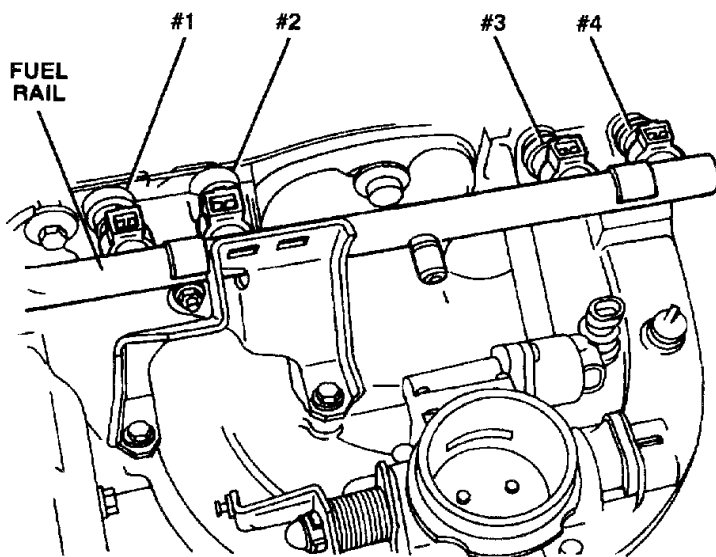

80b09806

Procedures (itype_376)

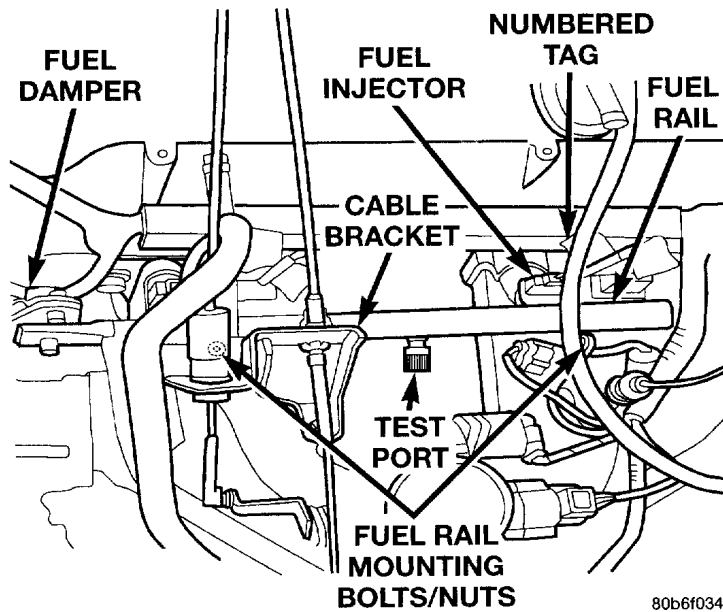

Technician Safety Information (itype_15)

WARNING: THE FUEL SYSTEM IS UNDER CONSTANT FUEL PRESSURE EVEN WITH ENGINE OFF. THIS PRESSURE MUST BE RELEASED BEFORE SERVICING FUEL RAIL

Mechanical (including Torque) (itype_28)

Fuel Rail Mounting Bolts 11 +/- 3 Nm