

# **Component Procedures: Positive Crankcase Ventilation Valve**

## **Table of Contents**

1. Parts and Labor (itype\_189)
2. Components (itype\_32)
3. Component Tests and General Diagnostics (itype\_383)

# Component Procedures: Positive Crankcase Ventilation Valve

## Parts and Labor (itype\_189)

### Parts

Qualifier	Part #	Name	Price	Note
PCV Valve	L32513890A	Pcv Valve	20.59	

### Labor

Operation	Qualifier Path	Skill	Std Hrs	Wty Hrs
Replace	Pcv Valve, R&R	B	2.7	1.9

## Components (itype\_32)

Engine Compartment Side

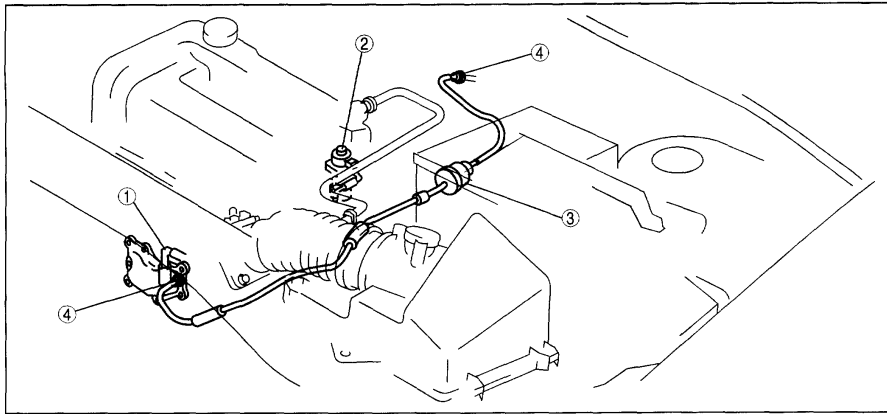

1	Positive crankcase ventilation (PCV) valve
2	EGR valve

3	Purge solenoid valve
4	Quick release connector (Type A)

## Component Tests and General Diagnostics (itype\_383)

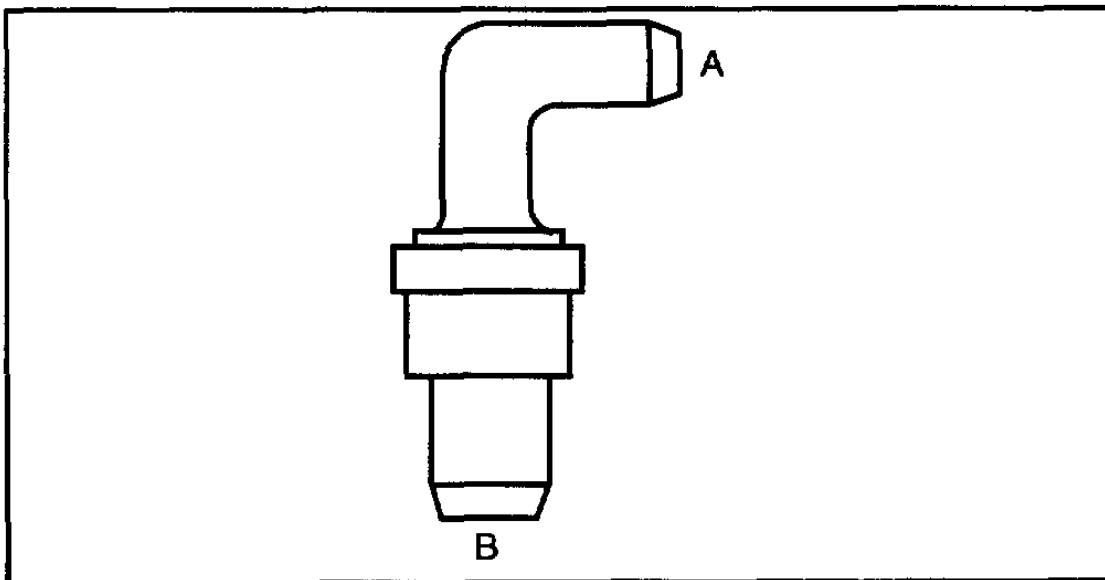

A6J3916W002