

Component Procedures: Air Bag Systems

Table of Contents

1. Parts and Labor (itype_189)
2. Electrical (OE) (itype_21)
3. Components (itype_32)
4. Service Warnings (Article 1385743)
5. Service Cautions (Article 1385744)
6. All Technical Service Bulletins (itype_100)
7. Troubleshooting Index (Article 1431932)
8. No.1 Air Bag System Warning Light Does Not Illuminate (Article 1441794)
9. No.2 Air Bag System Warning Light Illuminates Constantly (Article 1441827)

Component Procedures: Air Bag Systems

Parts and Labor (itype_189)

Labor

Operation	Qualifier Path	Skill	Std Hrs	Wty Hrs
Diagnose/Test	System, Diagnosis	B	0.5	0.0

Electrical (OE) (itype_21)

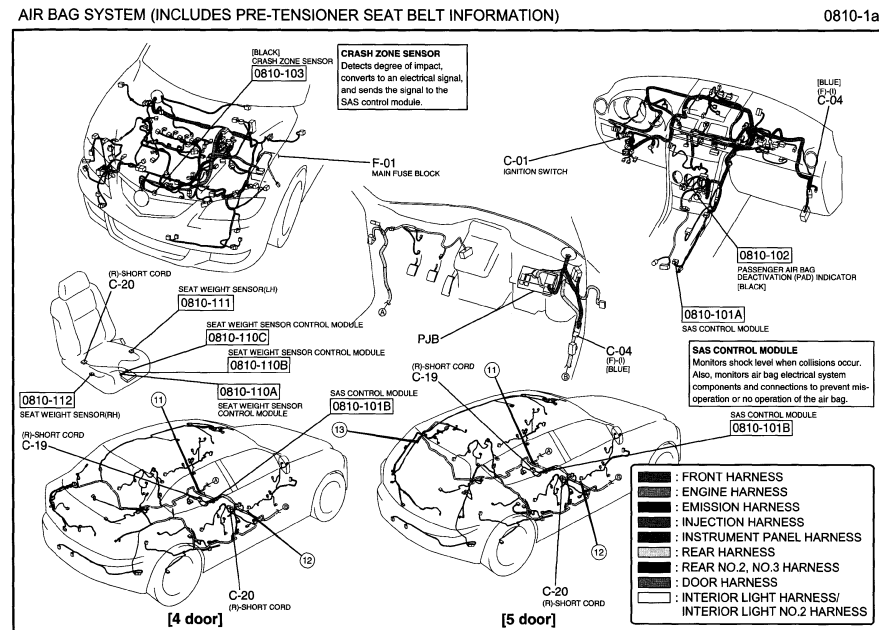
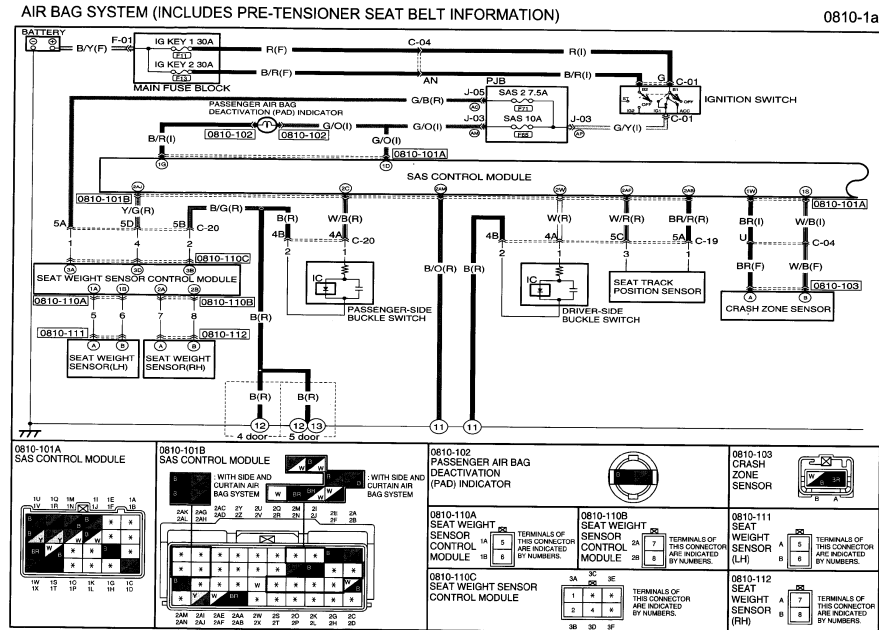

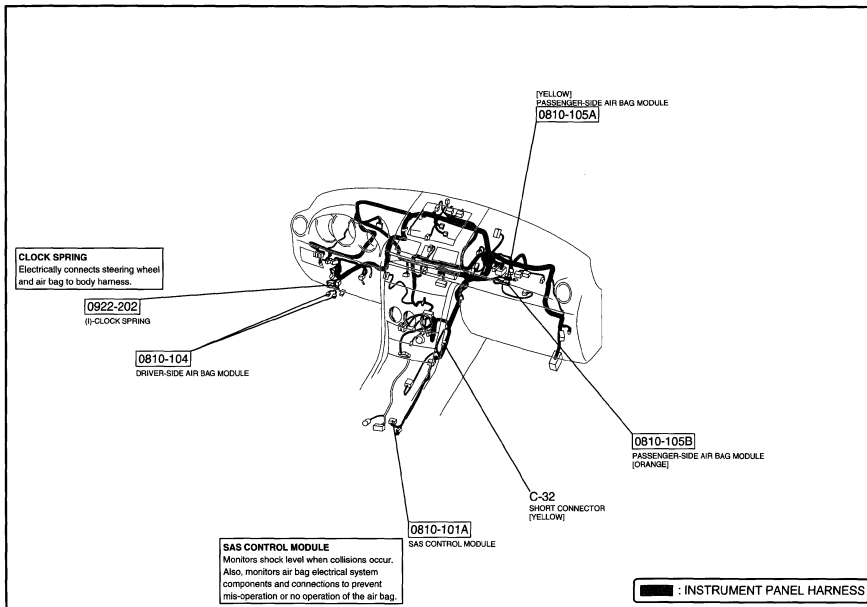
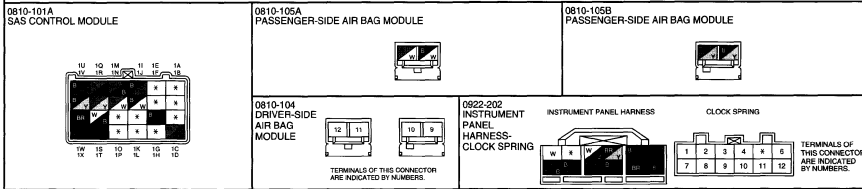
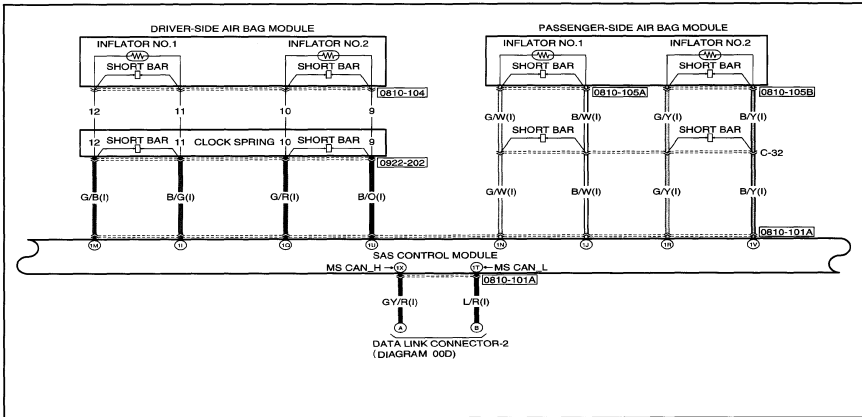

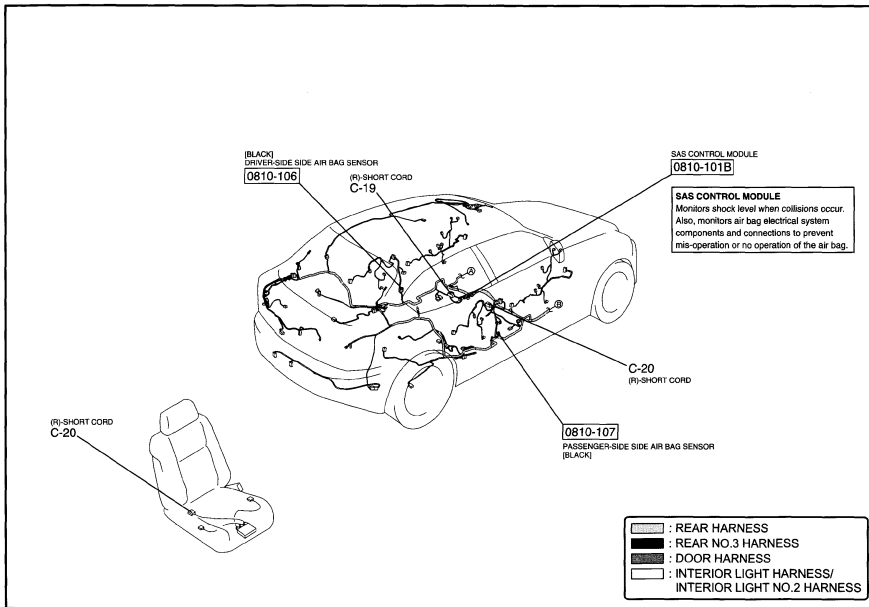
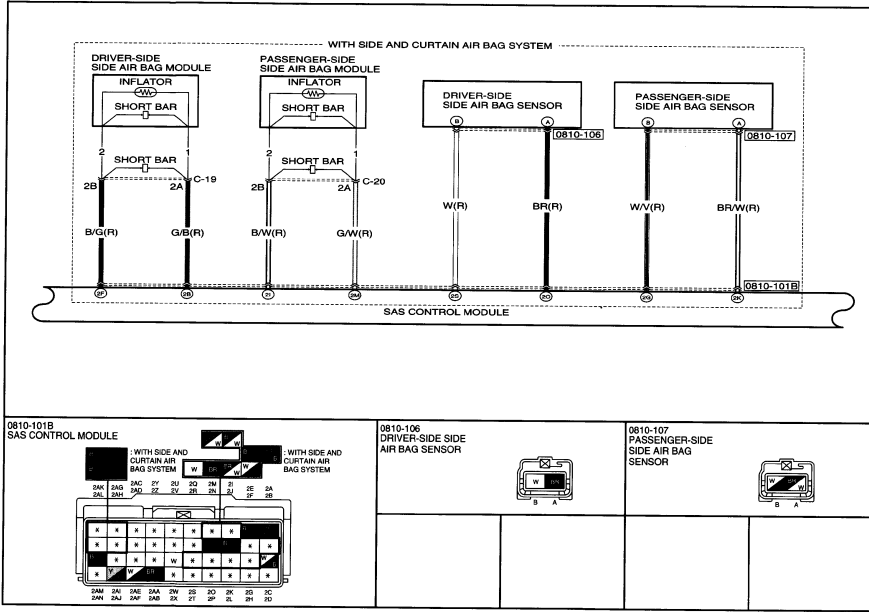

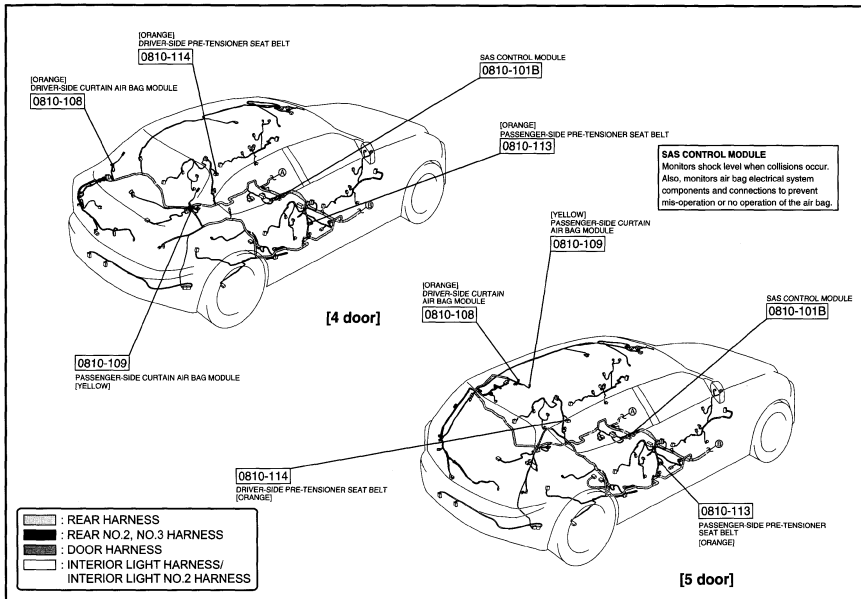
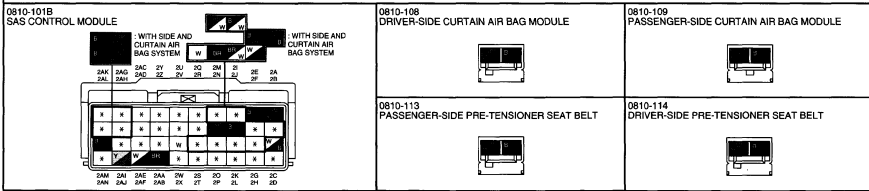
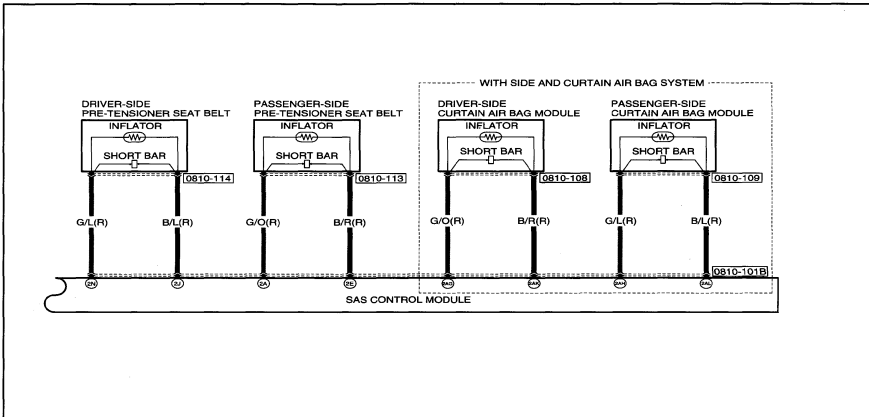

Components (itype_32)

LOCATION INDEX

92810000100

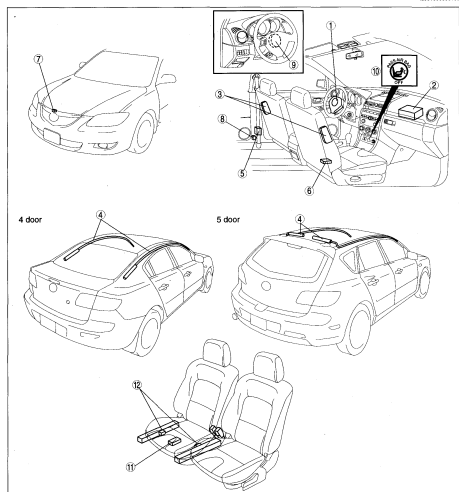

1	Driver-side air bag module	3	Side air bag module
2	Passenger-side air bag module	4	Curtain air bag module

5	Pre-tensioner seat belt
6	SAS control module
7	Crash zone sensor
8	Side air bag sensor

9	Clock spring
10	Passenger air bag deactivation (PAD) indicator
11	Seat weight sensor control module
12	Seat weight sensor

Service Warnings (Article 1385743)

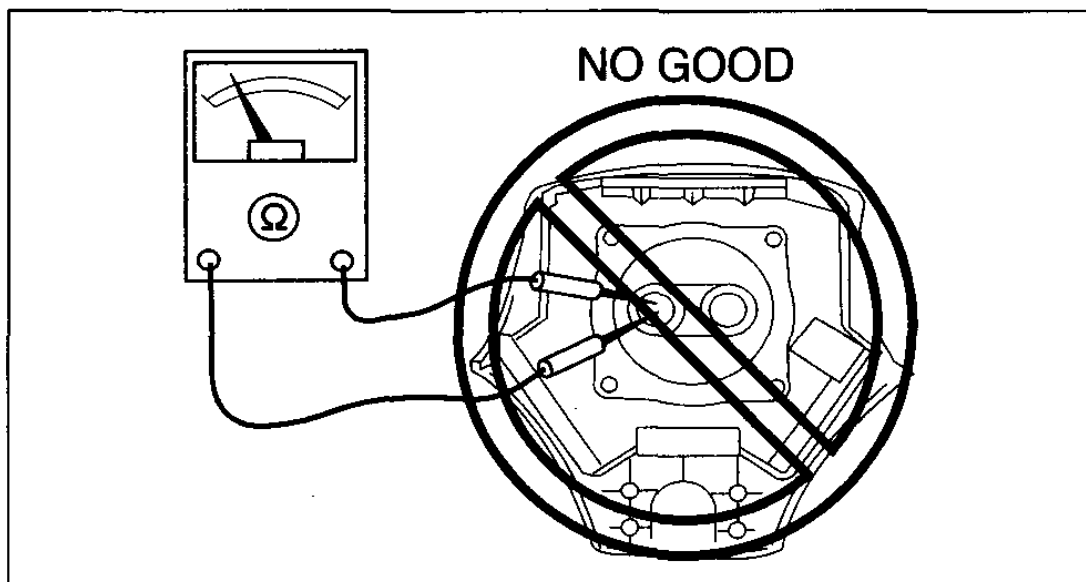

CHU0810W600

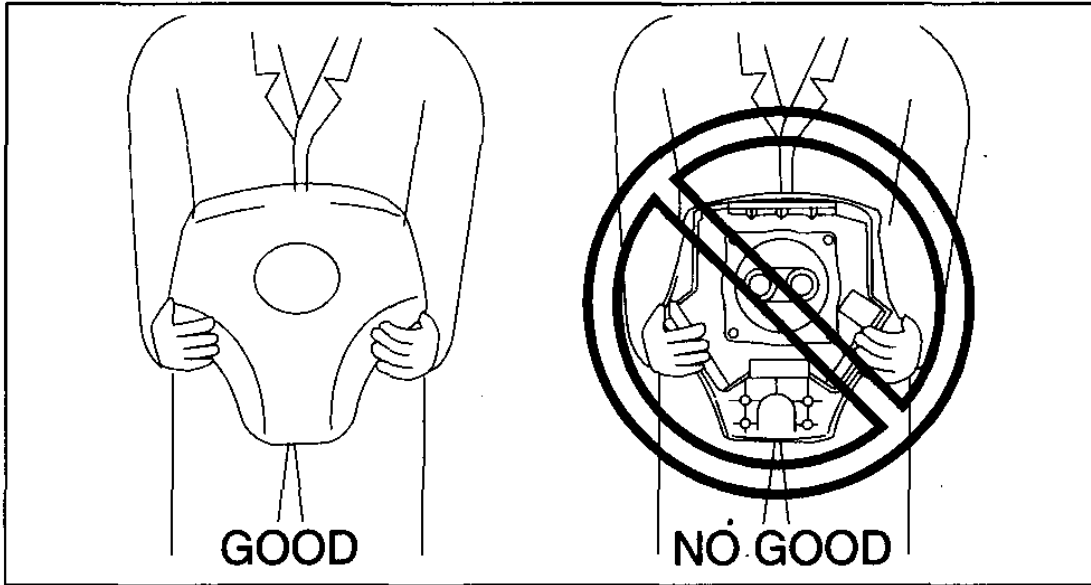

CHU0810W601

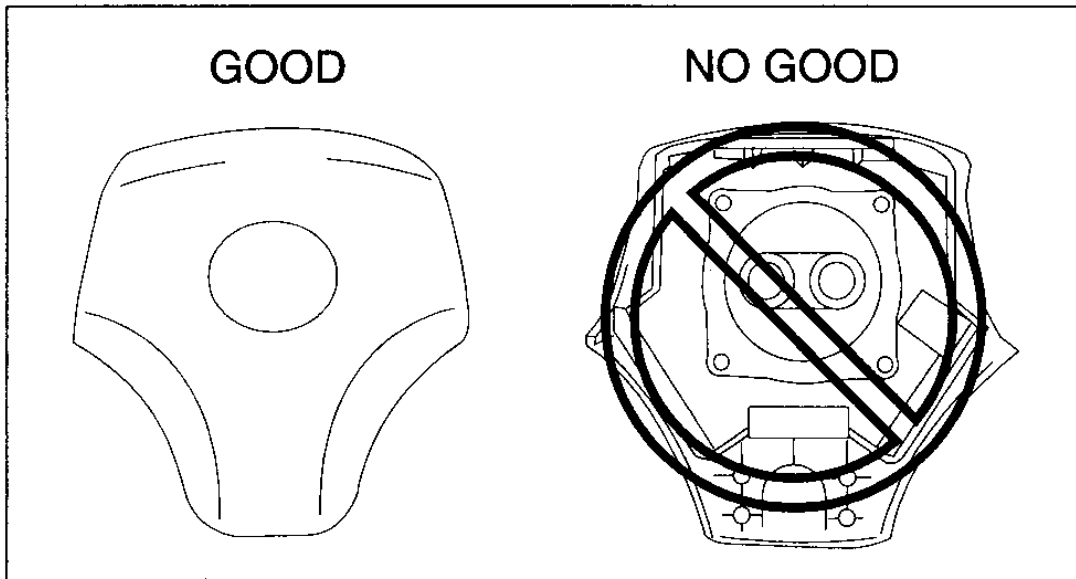

CHU0810W602

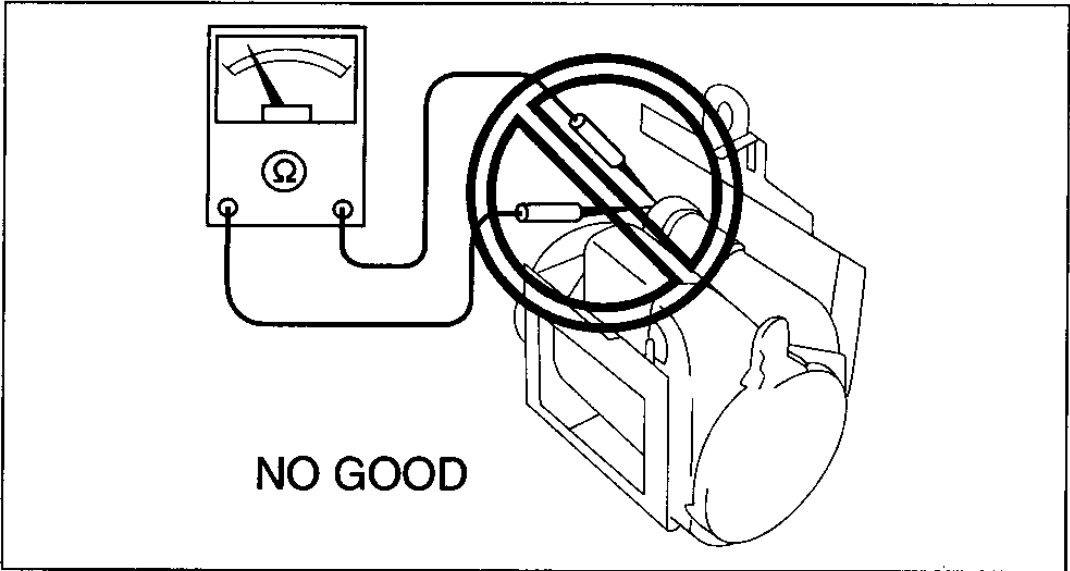

e3u810zw6004

Service Cautions (Article 1385744)

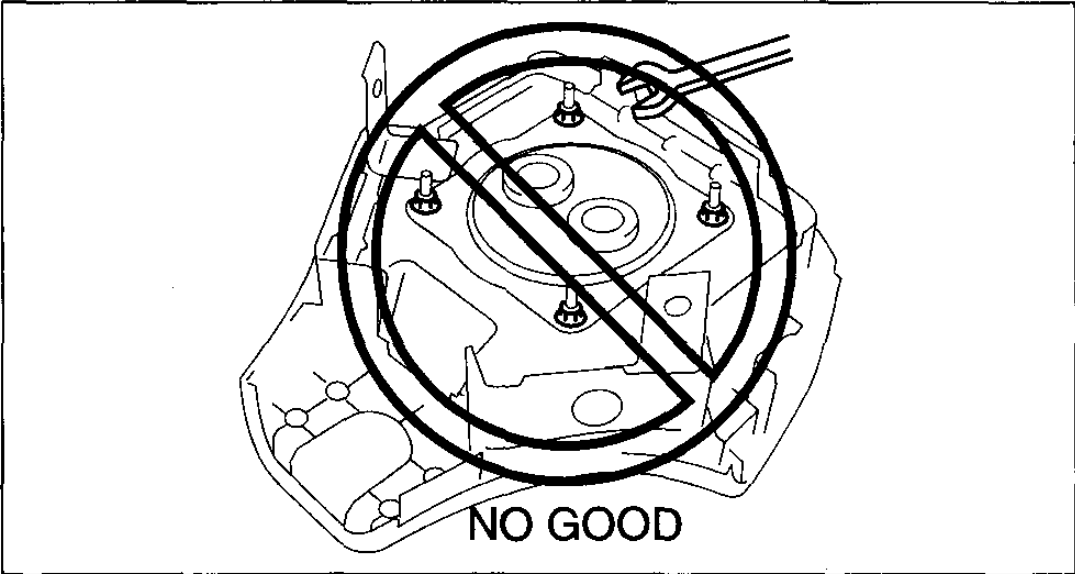

CHU0810W604

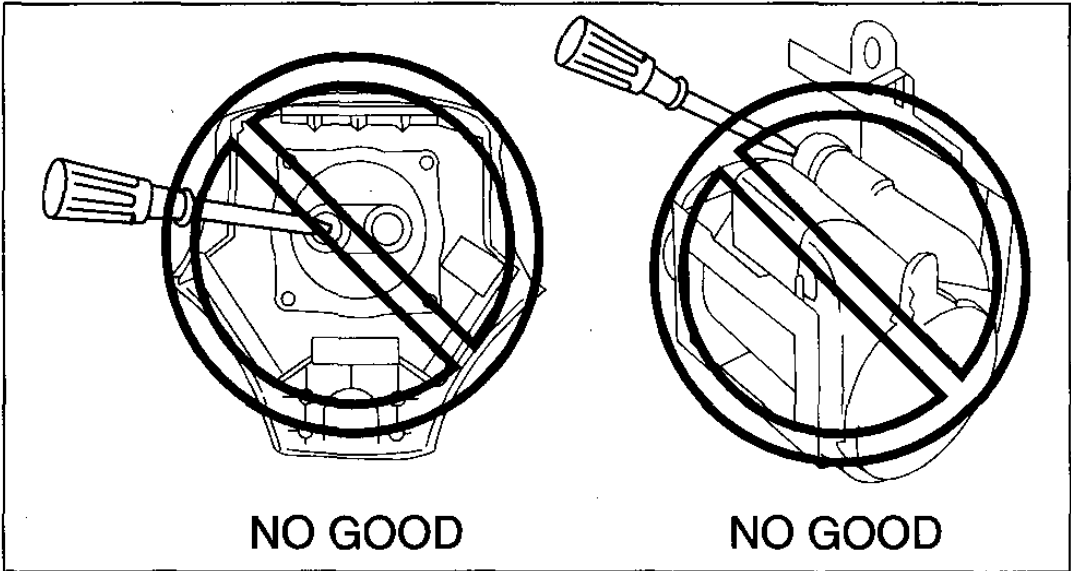

e3u810zw6005



CHU0810W606

All Technical Service Bulletins (itype_100)

Tsbs
- PASSENGER AIRBAG DEACTIVATION (PAD) INDICATOR LIGHT ILLUMINATION (08-001/19, 2019/01/10)

Troubleshooting Index (Article 1431932)

TROUBLESHOOTING INDEX

id080300802000

- Use the chart below verify the symptoms of the trouble in order to diagnose the appropriate area.

No.	Troubleshooting Item	Description
1	Air bag system warning light does not illuminate.	Malfunction in air bag system warning light circuit.
2	Air bag system warning light illuminates constantly.	Malfunction in air bag system warning light circuit.

No.1 Air Bag System Warning Light Does Not Illuminate (Article 1441794)

NO.1 AIR BAG SYSTEM WARNING LIGHT DOES NOT ILLUMINATE

id080300802000

1	Air bag system warning light does not illuminate.
DETECTION CONDITION	Malfunction in air bag system warning light circuit
POSSIBLE CAUSE	<ul style="list-style-type: none"> • SAS control module malfunction • Instrument cluster malfunction • CAN communication network malfunction

Diagnostic Procedure

STEP	INSPECTION	ACTION
1	CONFIRM DTC U0151 USING M-MDS <ul style="list-style-type: none"> • Retrieve DTC from the instrument cluster. • Is DTC U0151 retrieved? 	Yes Network communication for related systems has a malfunction. Repair or replace if necessary.
		No Inspect the instrument cluster. If the instrument cluster is normal, go to the next step. If the instrument cluster has a malfunction, replace the instrument cluster.
2	CONFIRM DTC B2477 FOR INSTRUMENT CLUSTER USING M-MDS <ul style="list-style-type: none"> • Is DTC B2477 retrieved? 	Yes Re-configure the instrument cluster.
		No Replace the SAS control module.

No.2 Air Bag System Warning Light Illuminates Constantly (Article 1441827)

NO.2 AIR BAG SYSTEM WARNING LIGHT ILLUMINATES CONSTANTLY

4200300600300

2	Air bag system warning light illuminates constantly.
DETECTION CONDITION	Malfunction in air bag system warning light circuit
POSSIBLE CAUSE	<ul style="list-style-type: none"> • SAS control module malfunction • Instrument cluster (circuit board) malfunction • CAN communication network malfunction

Diagnostic Procedure

- When performing an asterisked (*) troubleshooting inspection, slightly shake the wiring harness and connectors while performing the inspection to discover whether poor contact points are the cause of any intermittent malfunction. If there is a problem, verify that the connectors, terminals and wiring harness are connected correctly and undamaged.

STEP	INSPECTION		ACTION
1	VERIFY DTC IN SAS CONTROL MODULE MEMORY <ul style="list-style-type: none"> • Have DTCs been record in the memory? 	Yes	Perform inspection using appropriate DTC. (See DTC TABLE.)
		No	Inspect the instrument cluster. If the instrument cluster is normal, go to the next step. If the instrument cluster has a malfunction, replace the instrument cluster.
*2	INSPECT AIR BAG SYSTEM WARNING LIGHT CIRCUIT IN INSTRUMENT CLUSTER <ul style="list-style-type: none"> • Turn the ignition switch to the ON position. • Does air bag system warning light go out? 	Yes	Inspect the connectors and terminals of the SAS control module. Repair or replace if necessary.
		No	Go to the next step.
*3	INSPECT SAS CONTROL MODULE <ul style="list-style-type: none"> • Disconnect the SAS control module connector. • Turn the ignition switch to the ON position. • Verify the voltage at terminal 1D. • Is the voltage B+? 	Yes	Replace the SAS control module.
		No	Inspect the battery power supply circuit and ground circuit.