

Component Procedures: Keyless Entry Module

Table of Contents

1. Removal and Replacement (itype_401)
2. Component Tests and General Diagnostics (itype_383)
3. Pinout Values and Diagnostic Parameters (itype_385)

Component Procedures: Keyless Entry Module

Removal and Replacement (itype_401)

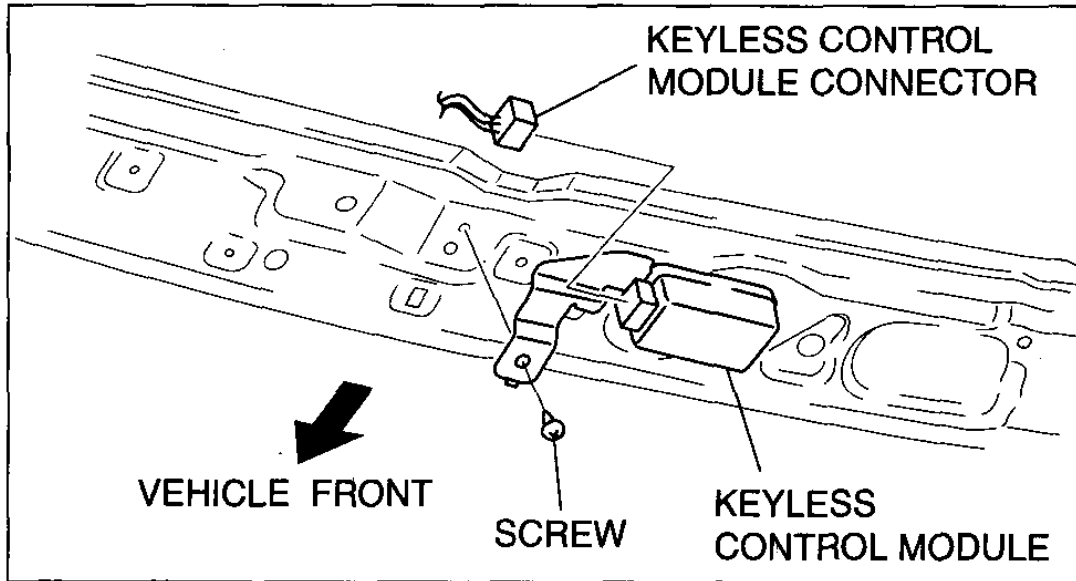

C3U0914W013

Component Tests and General Diagnostics (itype_383)

KEYLESS CONTROL MODULE INSPECTION

1. Measure the voltage or inspect for continuity according to the Terminal Voltage Table (Reference).
- If the voltage is not as specified in the Terminal Voltage Table (Reference), inspect the parts under "Inspection item(s)" and related wiring harnesses.
2. If the system does not work properly even though the inspection items or related wiring harnesses do not have any malfunction, perform symptom troubleshooting [KEYLESS ENTRY SYSTEM].

Pinout Values and Diagnostic Parameters (itype_385)

Terminal Voltage Table (Reference)

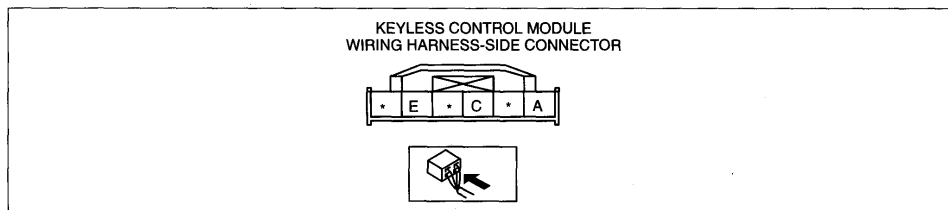

B3E0914W049

Terminal	Signal name	Connected to	Measured condition	Voltage (V)/ Continuity	Inspection item(s)
A	Power supply	PJB	Under any condition	B+	<ul style="list-style-type: none"> • PJB (See PASSENGER JUNCTION BOX (PJB) INSPECTION.) • Related wiring harnesses
C	Data	PJB	Under any condition: Inspect the wiring harness between the keyless control module and PJB terminal J-04 F for continuity.	Continuity detected	<ul style="list-style-type: none"> • PJB (See PASSENGER JUNCTION BOX (PJB) INSPECTION.) • transmitter (See TRANSMITTER BATTERY INSPECTION.) • Related wiring harnesses
E	GND	Body ground	Under any condition: Inspect for continuity to ground.	Continuity detected	GND