

Component Procedures: Differential Assembly

Table of Contents

1. Rear Axle (Article 163732)
2. Parts and Labor (itype_189)
3. Specifications Quick Reference (itype_439)
4. Rear Drive Axle (Article 10902)
5. Rear Drive Axle (Article 10814)
6. Rear Drive Axle (Article 10829)
7. Rear Drive Axle (Article 10863)
8. Rear Drive Axle (Article 10850)
9. Rear Drive Axle (Article 10887)
10. Rear Drive Axle (Article 10899)
11. Rear Drive Axle (Article 10889)
12. Vibration Diagnosis and Correction (Article 12604)
13. Rear Drive Axle (Article 10817)
14. Rear Drive Axle (Article 10885)

Component Procedures: Differential Assembly

Rear Axle (Article 163732)

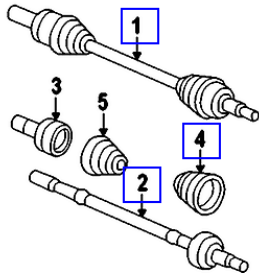
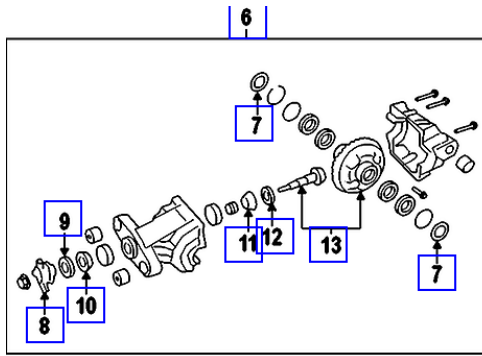

Parts and Labor (itype_189)

Labor

Operation	Qualifier Path	Skill	Std Hrs	Wty Hrs
Remove & Install	Rear Axle > Final Drive Assembly, R&I	B	5.5	4.1
Remove & Install	Rear Axle > Final Drive Assembly, R&I > NOTE ?		0.4	
Remove & Install	Rear Axle > Final Drive Assembly, R&I > NOTE ?		0.2	
Remove & Install	Rear Axle > Final Drive Assembly, R&I > NOTE ?		0.1	
Remove & Install	Rear Axle > Final Drive Assembly, R&I > NOTE ?		0.8	
Remove & Install	Rear Axle > Final Drive Assembly, R&I > NOTE ?		0.5	
Remove & Install	Rear Axle > Final Drive Assembly, R&I > NOTE ?		0.2	
Remove & Install	Rear Axle > Final Drive Assembly, R&I > NOTE ?		0.2	
Remove & Install	Rear Axle > Final Drive Assembly, R&I > NOTE ?		1.0	
Remove & Install	Rear Axle > Final Drive Assembly, R&I > NOTE ?		0.4	
Remove & Replace	Rear Axle > Differential > Companion Flange, ?	B	1.5	0.0
Remove & Replace	Rear Axle > Differential > Pinion Seal, R&R	B	1.8	1.4
Remove & Replace	Rear Axle > Final Drive Assembly, R&R > See F?			0.0
Remove & Replace	Rear Axle > Housing Cover, R&R	B	5.8	0.0
Remove & Replace	Rear Axle > Housing Cover, R&R > NOTE > To R&?		0.2	
Change	Differential > Fluid, Change	C	0.5	0.0

Specifications Quick Reference (itype_439)

Quick Specifications

- item

Rear Drive Axle (Article 10902)

Non Standards

- Rear Axle Identification (10903)

Rear Drive Axle (Article 10814)

Non Standards

- Limited Slip Differential (10815)

- Rear Drive Axle Description and Operation (10816)

Rear Drive Axle (Article 10829)

Non Standards

- Drive Pinion Flange/Yoke and/or Oil Seal Replacement (250 MM Axle) (10860)
- Repair Instructions (10830)

Rear Drive Axle (Article 10863)

Non Standards

- Gear Tooth Contact Pattern Inspection (10864)

Rear Drive Axle (Article 10850)

Non Standards

- Differential Replacement (250 MM Axle) (10852)

Rear Drive Axle (Article 10887)

Non Standards

- Rear Drive Axle - Adhesives, Fluids, Lubricants, and Sealers (10888)

Rear Drive Axle (Article 10899)

Non Standards

- Rear Drive Axle - Fastener Specifications (10900)

Rear Drive Axle (Article 10889)

Non Standards

- Rear Drive Axle - Adhesives, Fluids, Lubricants, and Sealers (10890)

Vibration Diagnosis and Correction (Article 12604)

Non Standards

- Differential Pinion Input Shaft Runout Measurement (12605)

Rear Drive Axle (Article 10817)

Non Standards

- Symptoms - Locking/Limited Slip Rear Axle (10827)
- Symptoms - Rear Drive Axle (10828)
- Rear Drive Axle Noises (10826)
- Noisy in Drive (10822)
- Noisy When Coasting (10824)
- Intermittent Noise (10819)
- Constant Noise - Rear Drive Axle (10818)
- Noisy on Turns (10823)
- Rear Axle Lubricant Leak Diagnosis (10825)
- Limited Slip Differential Diagnosis (10821)
- Limited Slip Differential Chatters in Turns (10820)

Rear Drive Axle (Article 10885)

Non Standards

- Rear Drive Axle - Rear Drive Axle - Special Tools (10886)