

# **Component Procedures: Coolant Temperature Sensor/Switch (For Computer)**

## **Table of Contents**

1. Parts and Labor (itype\_189)
2. Engine Coolant Temperature Sensor (ECTS) - Description and Operation (Article 44209)
3. Engine Coolant Temperature Sensor (ECTS) - Schematic Diagrams (Article 44211)
4. Engine Coolant Temperature Sensor (ECTS) - Repair Procedures (Article 44213)
5. Engine Coolant Temperature Sensor (ECTS) - Specifications (Article 44210)

# Component Procedures: Coolant Temperature Sensor/Switch (For Computer)

## Parts and Labor (itype\_189)

### Parts

Qualifier	Part #	Name	Price	Note
Powertrain Control	3922038030	Coolant Temp Sensor	68.69	

### Labor

Operation	Qualifier Path	Skill	Std Hrs	Wty Hrs
Remove & Replace	Powertrain Control > Coolant Temp Sensor, R&R	B	0.5	0.0

## Engine Coolant Temperature Sensor (ECTS) - Description and Operation (Article 44209)

- Description

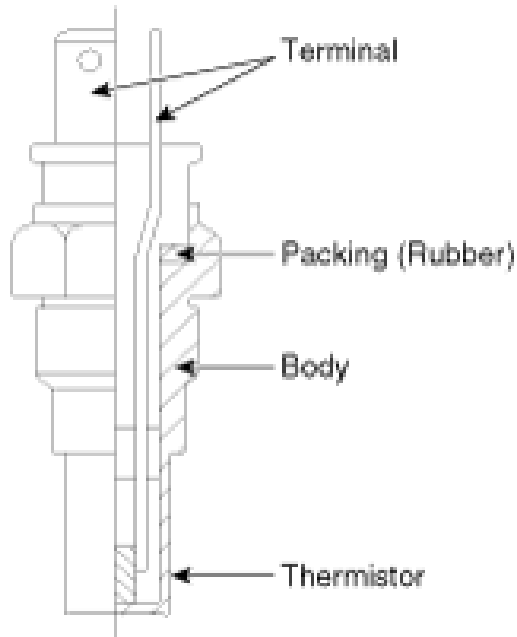

## Engine Coolant Temperature Sensor (ECTS) - Schematic Diagrams (Article 44211)

- Circuit Diagram

[Circuit Diagram]

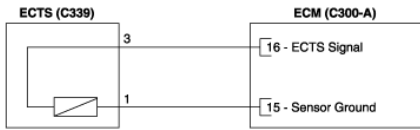

[Connection Information]

Terminal	Connected to	Function
1	ECM C300-A (15)	Sensor Ground
2	-	-
3	ECM C300-A (16)	ECTS Signal

[Harness Connector]

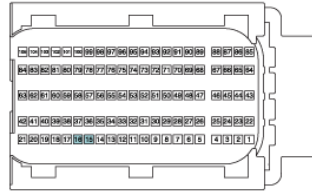

C300-A

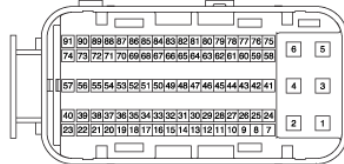

C300-B  
ECM

## Engine Coolant Temperature Sensor (ECTS) - Repair Procedures (Article 44213)

- Inspection
- Turn the ignition switch OFF.
- Disconnect the ECTS connector.
- Remove the ECTS.
- After immersing the thermistor of the sensor into engine coolant, measure resistance between the ECTS terminals 1 and 3.
- Check that the resistance is within the specification. Specification : Refer to "Specification"
- Removal
- Turn the ignition switch OFF and disconnect the battery negative (-) cable.
- Disconnect the engine coolant temperature sensor connector (A).
- Remove the sensor (B). Note that engine coolant may be flowed out from the water temperature control assembly when removing the sensor.

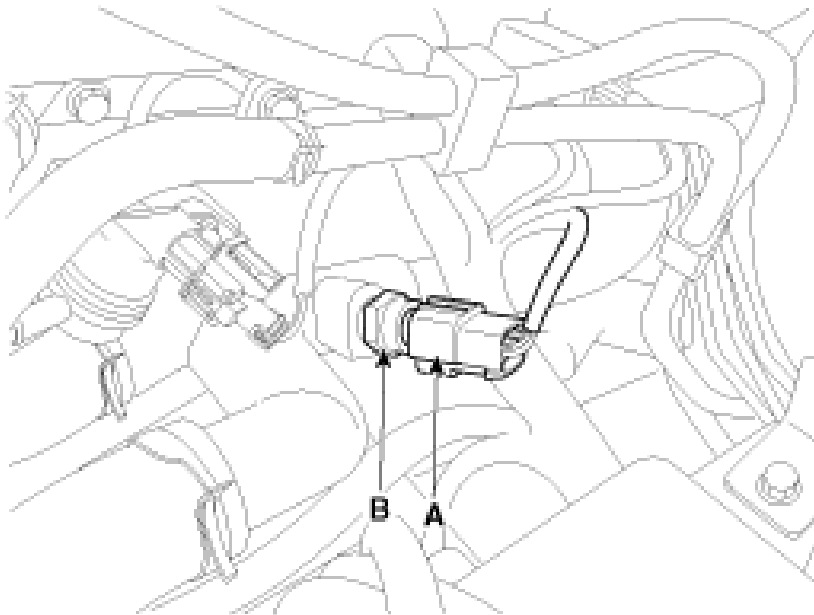

Note that engine coolant may be flowed out from the water temperature control assembly when removing the sensor.

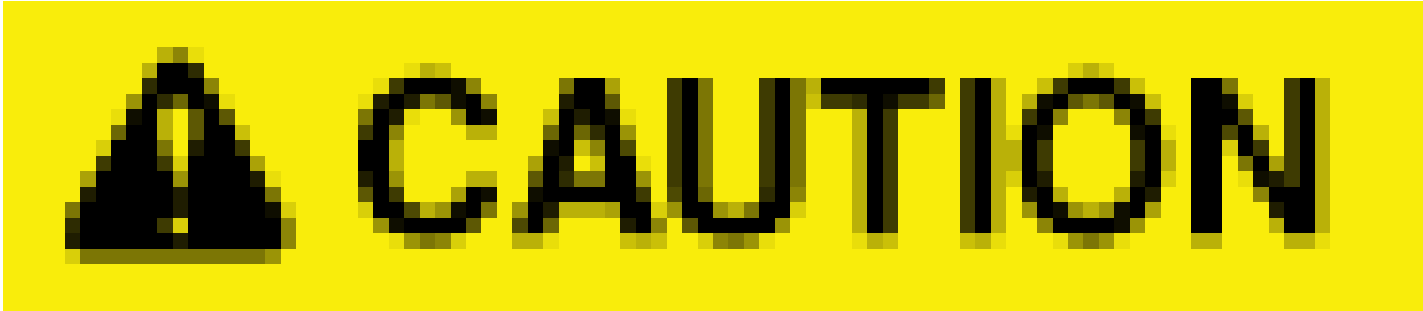

- Note that engine coolant may be flowed out from the water temperature control assembly when removing the sensor.

- Supplement the engine coolant. (Refer to Engine Mechanical System - "Coolant")

- Installation

Install the component with the specified torques. Note that internal damage may occur when the component is dropped.

- Install the component with the specified torques.

- Note that internal damage may occur when the component is dropped.

Apply the engine coolant to the O-ring.

- Apply the engine coolant to the O-ring.

Insert the sensor in the installation hole and be careful not to damage.

- Insert the sensor in the installation hole and be careful not to damage.

- Installation is reverse of removal. Engine coolant temperature sensor installation : 29.4 - 39.2 N.m (3.0 - 4.0 kgf.m, 21.7 - 28.9 lb-ft)

### **Engine Coolant Temperature Sensor (ECTS) - Specifications (Article 44210)**

- Specification

Temperature Resistance (k $\Omega$ )

°C °F

-40 -40 48.14

-20 -4 14.13 - 16.83

0 32 5.79

20 68 2.31 - 2.59

40 104 1.15

60 140 0.59

80 176 0.32