

# **Component Procedures: Exhaust Manifold**

## **Table of Contents**

1. Parts and Labor (itype\_189)
2. Exhaust Manifold - Components and Components Location (Article 45395)
3. Exhaust Manifold - Repair Procedures (Article 45396)

# Component Procedures: Exhaust Manifold

## Parts and Labor (itype\_189)

### Parts

Qualifier	Part #	Name	Price	Note
Exhaust Manifold > Exhaust M?	285102EHA0	Sulev Emission	3662.74	
Exhaust Manifold > Exhaust M?	285102EHB0	Ulev Emission	2543.35	
Exhaust Manifold > Exhaust M?	285102EFB0	Manual Trans	3112.79	
Exhaust Manifold > Exhaust M?	285102EFA0	Emission Sulev	2738.40	
Exhaust Manifold > Exhaust M?	285102EFB0	Emission Ulev	3112.79	

### Labor

Operation	Qualifier Path	Skill	Std Hrs	Wty Hrs
Remove & Replace	Exhaust Manifold > Exhaust Manifold, R&R	B	1.6	0.0

## Exhaust Manifold - Components and Components Location (Article 45395)

### - Components

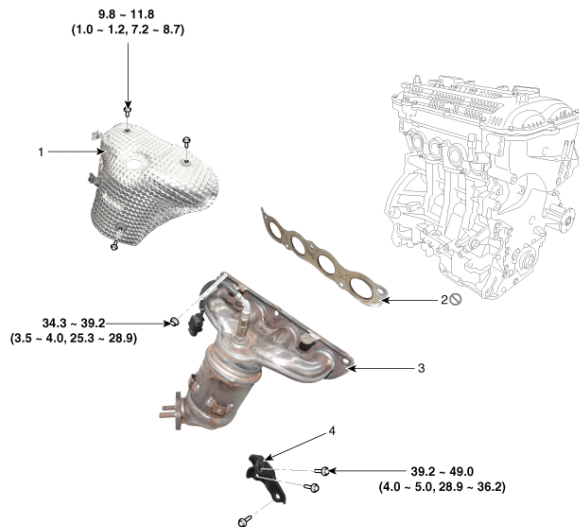

Tightening torque : N.m (kgf.m, lb-ft)

1. Heat protector 2. Exhaust manifold gasket 3. Exhaust manifold 4. Exhaust manifold stay

## Exhaust Manifold - Repair Procedures (Article 45396)

- Removal and Installation
- Remove the engine cover . (Refer to Engine and Transaxle Assembly - "Engine Cover")
- Disconnect the battery negative terminal.
- Disconnect the oxygen sensor connectors (A).

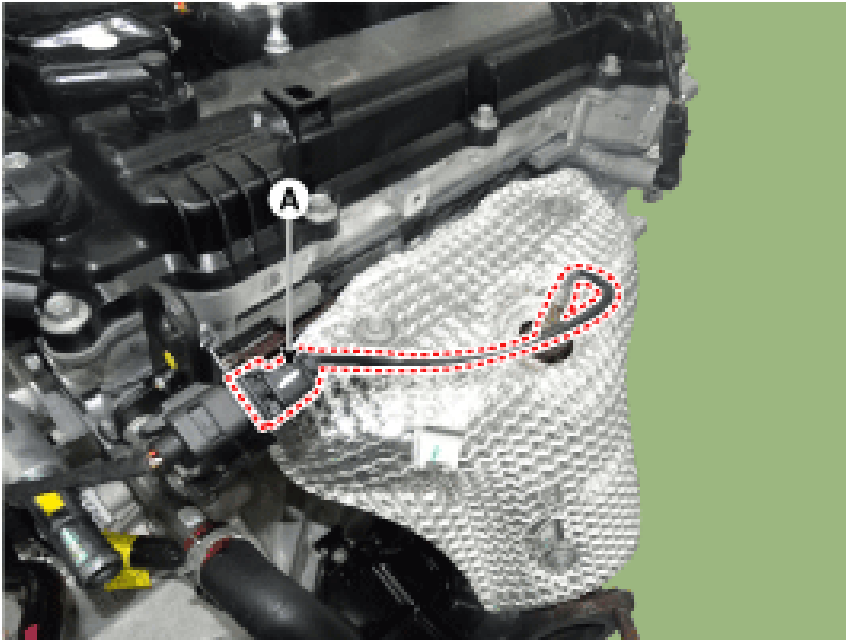

- Remove the engine room under cover . (Refer to Engine and Transaxle Assembly - "Engine Room Under Cover")
- Remove the front muffler . (Refer to Intake and Exhaust System - "Muffler")
- Remove the exhaust manifold heat protector (A). Tightening torque : 9.8 - 11.8 N.m (1.0 - 1.2 kgf.m, 7.2 - 8.7 lb-ft)

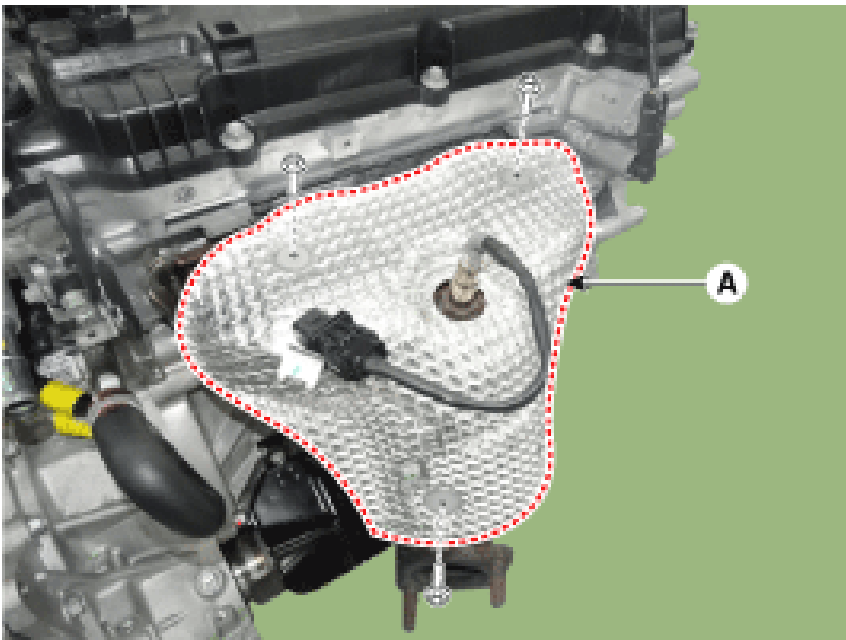

- Remove the driveshaft heat protector (A). Tightening torque : 19.6 - 29.4 N.m (2.0 - 3.0 kgf.m, 14.5 - 21.7 lb-ft)

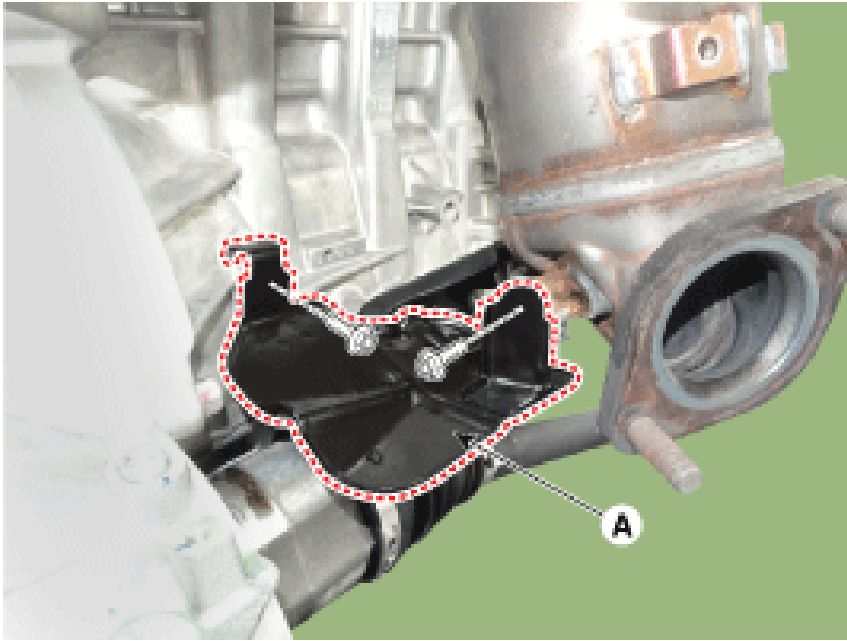

- Remove the exhaust manifold stay (A). Tightening torque : 39.2 - 49.0 N.m (4.0 - 5.0 kgf.m, 28.9 - 36.2 lb-ft)

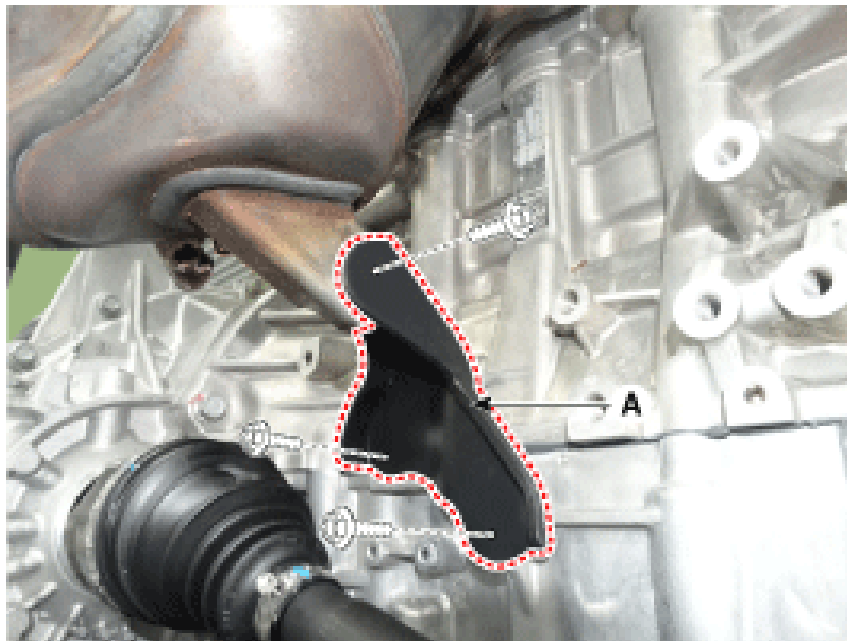

- Remove the exhaust manifold (A) with the gasket. Tightening torque : 34.3 - 39.2 N.m(3.5 - 4.0 kgf.m, 25.3 - 28.9 lb-ft) When installing the intake manifold , tighten the nuts with pre-torque first, and then tighten the nuts with specified torque in the sequence shown.

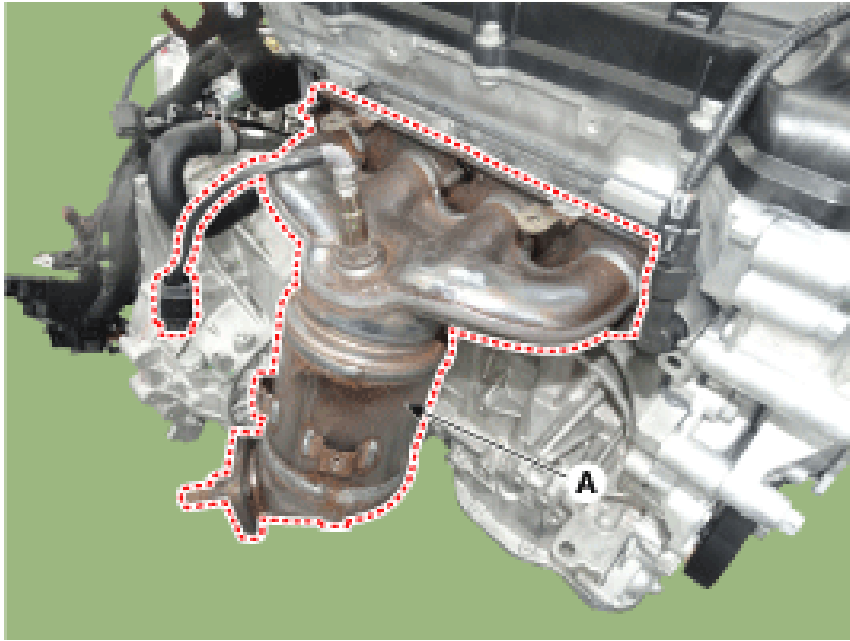

When installing the intake manifold , tighten the nuts with pre-torque first, and then tighten the nuts with specified torque in the sequence shown.

# NOTICE

- When installing the intake manifold , tighten the nuts with pre-torque first, and then tighten the nuts with specified torque in the sequence shown.



- Install in the reverse order of removal. When installing, replace with a new gasket.  
When installing, replace with a new gasket.  
- When installing, replace with a new gasket.