

Component Procedures: Fuel Pressure Regulator

Table of Contents

1. Parts and Labor (itype_189)
2. Fuel Pressure Regulator - Repair Procedures (Article 44235)

Component Procedures: Fuel Pressure Regulator

Parts and Labor (itype_189)

Labor

Operation	Qualifier Path	Skill	Std Hrs	Wty Hrs
Remove & Replace	Fuel Injection > Fuel Pressure Regulator, R&R	B	1.3	0.0

Fuel Pressure Regulator - Repair Procedures (Article 44235)

- Removal
- Remove the fuel pump . (Refer to Fuel Delivery System - "Fuel Pump")
- Disconnect the electric pump wiring connector (A) and the fuel sender connector (B).

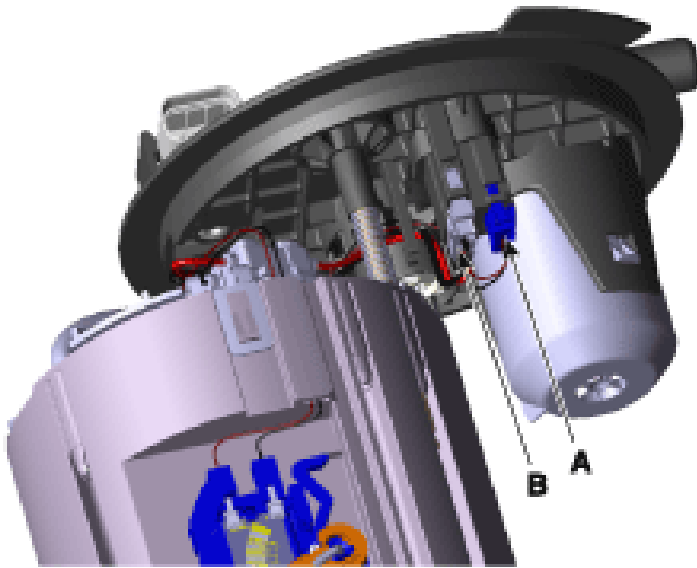

- Remove the head assembly (A) after releasing the cushion fixing hooks.
- Disconnect the fuel tube quick-connectors (B).

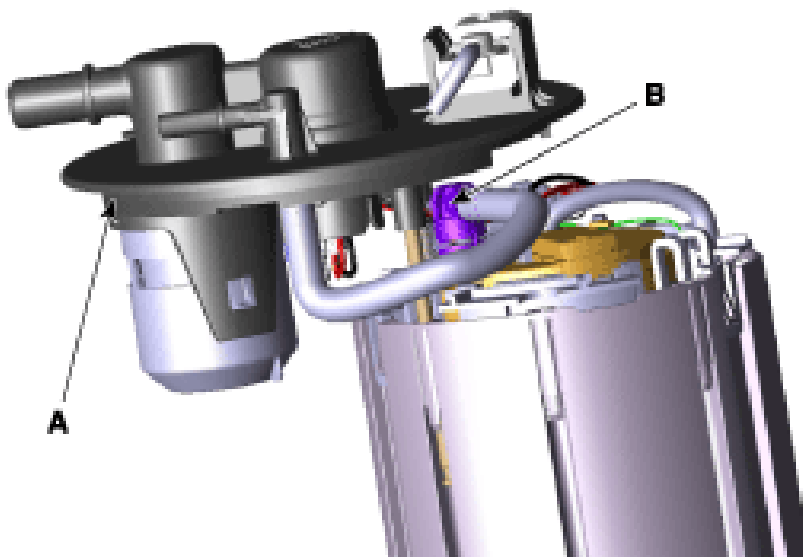

- Remove the fuel sender (A) in the direction of an arrow.

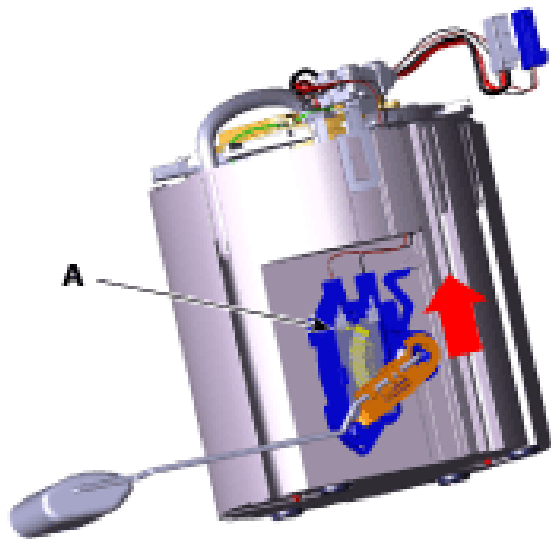

- Remove the reservoir-cup (B) after releasing the fixing hooks (A).

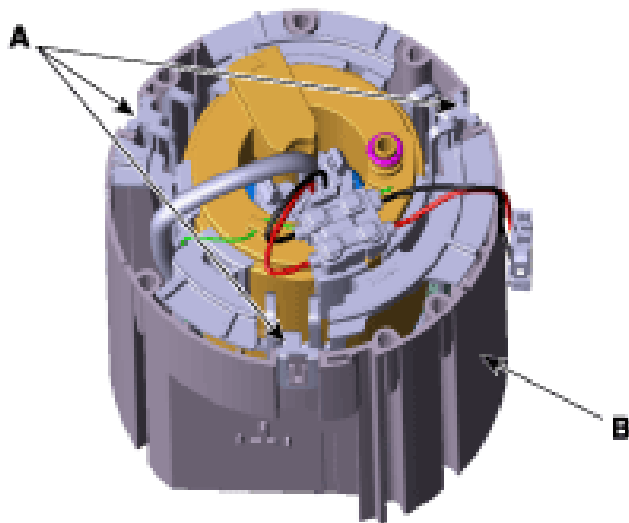

- Release the fixing hooks, and then remove the fuel pressure regulator (A).

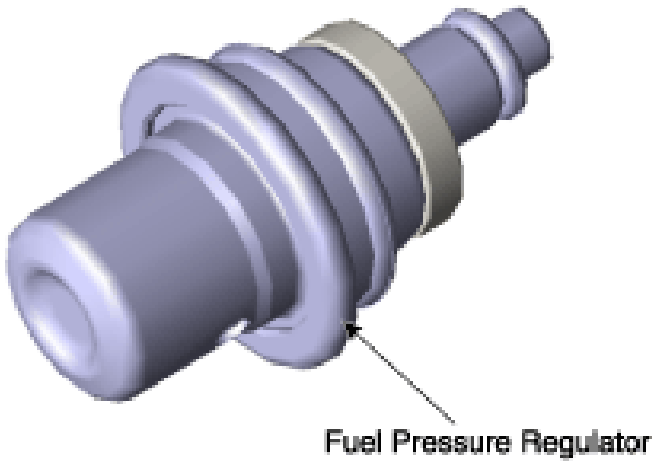
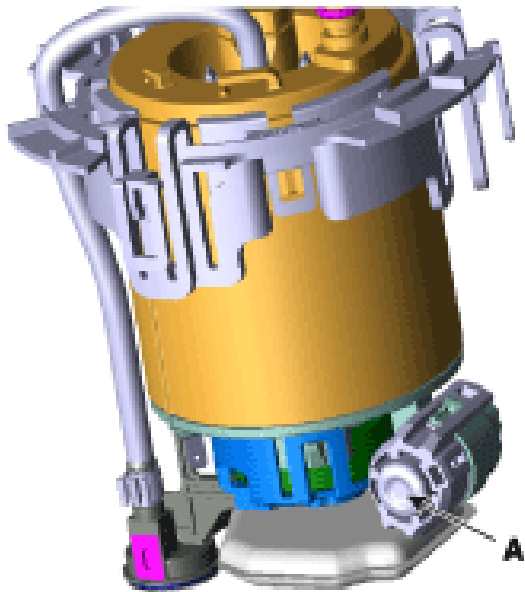

- Installation
- Installation is reverse of removal.