

Component Procedures: Oil Temperature Sensor For ECM

Table of Contents

1. CVVT Oil Control Valve (OCV) - Description and Operation (Article 44158)
2. CVVT Oil Control Valve (OCV) - Schematic Diagrams (Article 44167)
3. CVVT Oil Control Valve (OCV) - Repair Procedures (Article 44171)
4. CVVT Oil Control Valve (OCV) - Specifications (Article 44162)

Component Procedures: Oil Temperature Sensor For ECM

CVVT Oil Control Valve (OCV) - Description and Operation (Article 44158)

- Description

[Bank 1 / Intake] #1

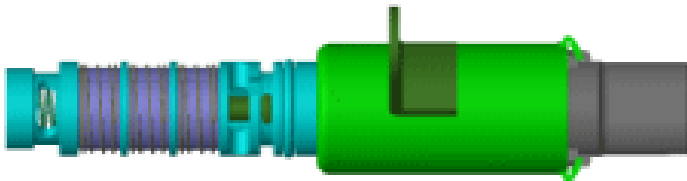

[Bank 1 / Intake] #2



[Bank 1 / Exhaust]

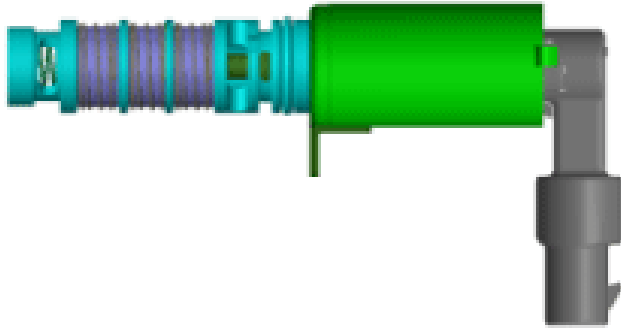

CVVT Oil Control Valve (OCV) - Schematic Diagrams (Article 44167)

- Circuit Diagram

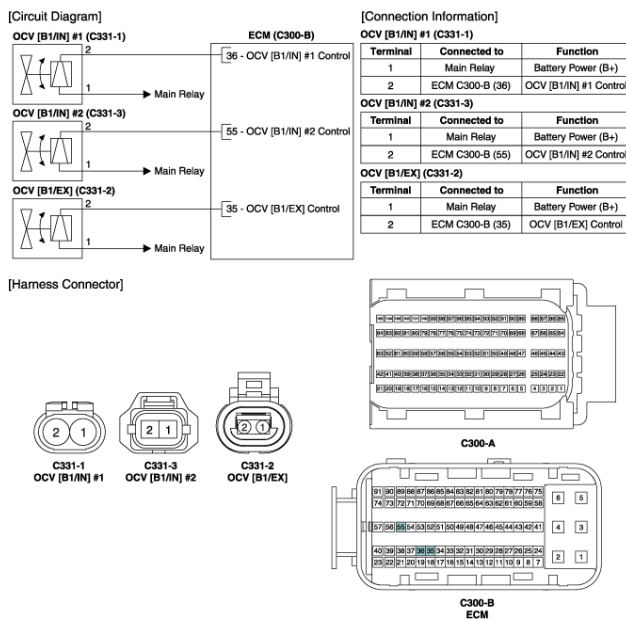

CVVT Oil Control Valve (OCV) - Repair Procedures (Article 44171)

- Inspection
- Turn the ignition switch OFF.
- Disconnect the OCV connector.
- Measure resistance between the OCV terminals 1 and 2.
- Check that the resistance is within the specification. Specification : Refer to "Specification"
- Removal
- Turn the ignition switch OFF and disconnect the battery negative (-) cable.
- Disconnect the CVVT oil control valve connector (A).
- Remove the installation bolt (B), and then remove the valve from the engine. [Bank 1 / Intake] #1 [Bank 1 / Intake] #2 [Bank 1 / Exhaust] #1

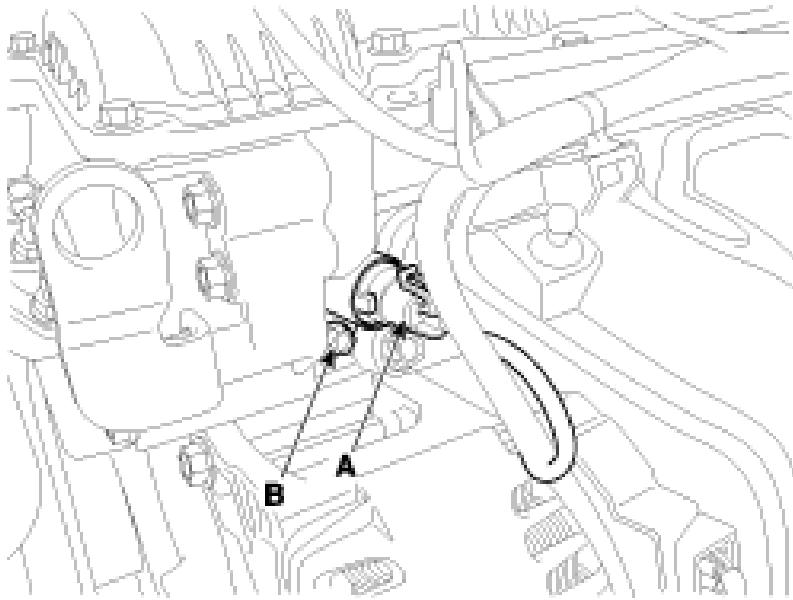

[Bank 1 / Intake] #2

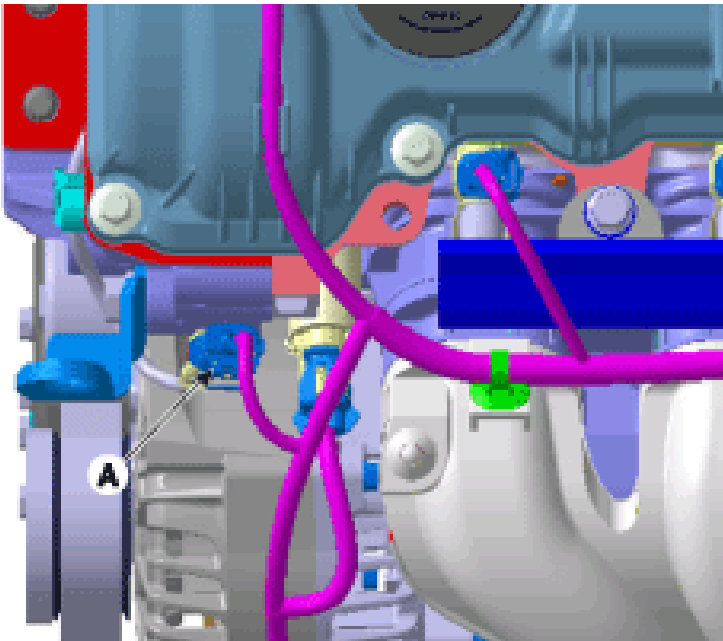

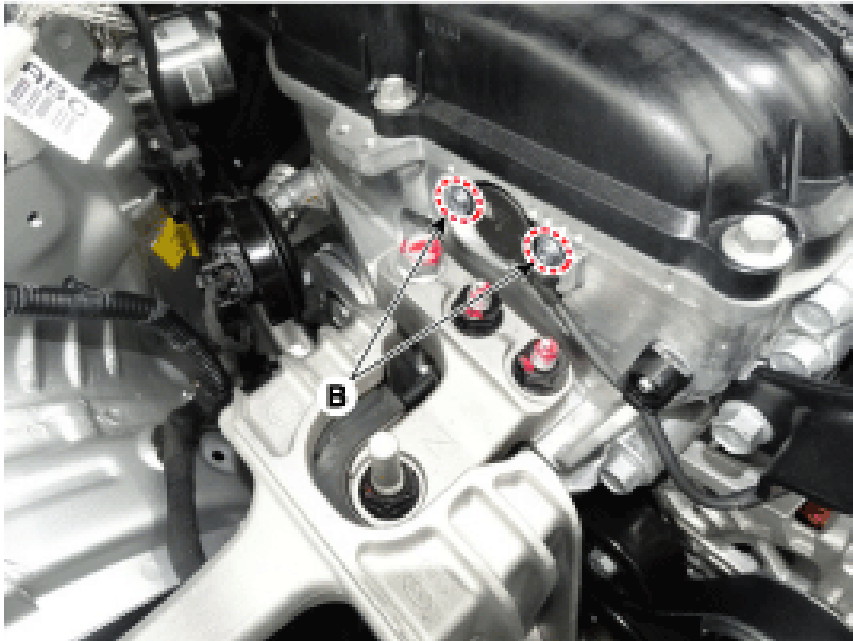

[Bank 1 / Exhaust]

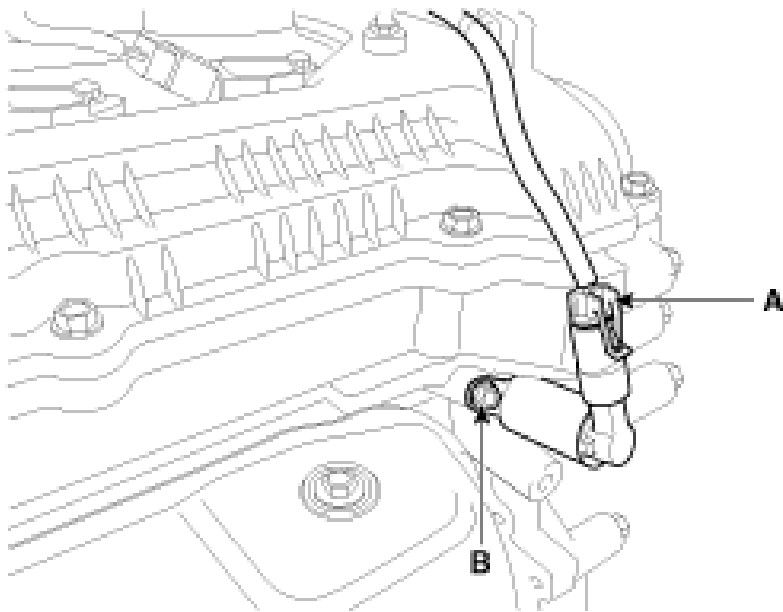

- Installation

Install the component with the specified torques. Note that internal damage may occur when the component is dropped. In this case, use it after inspecting.



- Install the component with the specified torques.
- Note that internal damage may occur when the component is dropped. In this case, use it after inspecting.
- Apply engine oil to the valve O-ring.
- Apply engine oil to the valve O-ring.

- Installation is reverse of removal. CVVT oil control valve installation bolt : 9.8 - 11.8 N.m (1.0 - 1.2 kgf.m, 7.2 - 8.7 lb-ft)

CVVT Oil Control Valve (OCV) - Specifications (Article 44162)

- Specification

[Bank 1 / Intake] #1 , [Bank 1 / Exhaust]

Item Specification

Coil Resistance (Ω) 9.4 - 10.4 [20°C (68°F)]

[Bank 1 / Intake] #2

Coil Resistance (Ω) 10.8 - 12.8 [20°C (68°F)]