

Component Procedures: Positive Crankcase Ventilation Valve

Table of Contents

1. Parts and Labor (itype_189)
2. Positive Crankcase Ventilation (PCV) Valve - Description and Operation (Article 44095)
3. Positive Crankcase Ventilation (PCV) Valve - Repair Procedures (Article 44096)

Component Procedures: Positive Crankcase Ventilation Valve

Parts and Labor (itype_189)

Parts

Qualifier	Part #	Name	Price	Note
Emission System > PCV Valve	267402G000	Pcv Valve	24.06	

Labor

Operation	Qualifier Path	Skill	Std Hrs	Wty Hrs
Remove & Replace	Emission System > PCV Valve, R&R	C	0.3	0.0

Positive Crankcase Ventilation (PCV) Valve - Description and Operation (Article 44095)

- Operation Principle

Engine Condition	Not Running	Idling or Decelerating	Normal Operation	Accelerating and High Load
Vacuum in Intake Manifold	0	High	Moderate	Low
PCV Valve	Close	Slightly Open	Properly Open	Fully Open
Blow-by Gas Flow	0	Small	Medium	Large
Schematic Diagram				

Positive Crankcase Ventilation (PCV) Valve - Repair Procedures (Article 44096)

- Removal
- Disconnect the vapor hose (A).
- Remove the PCV valve (B).

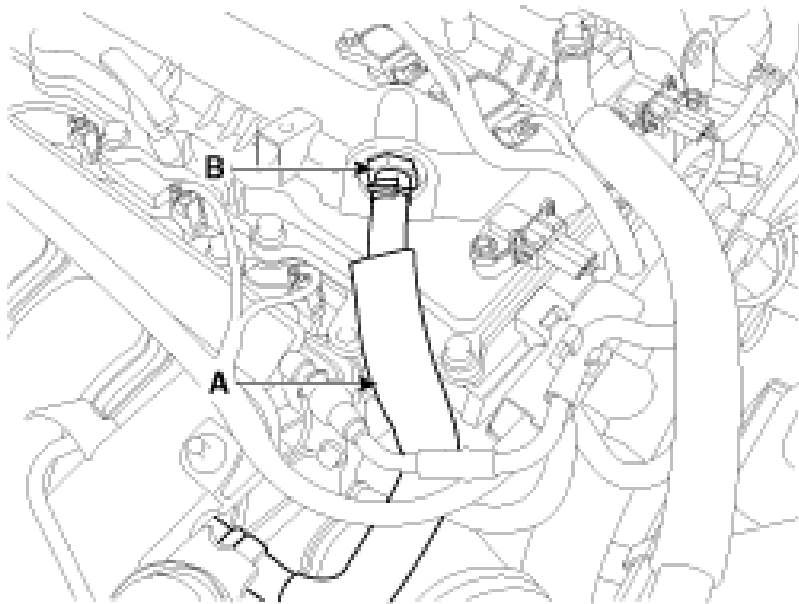

- Inspection
- Insert a thin stick (A) into the PCV valve (B) from the threaded side to check that the plunger movement. If the plunger does not move (PCV valve is clogged), clean or replace the valve.

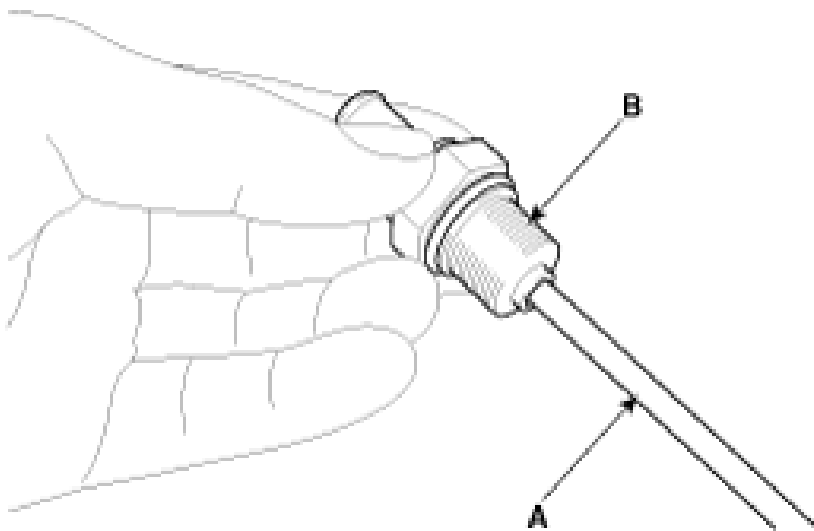

If the plunger does not move (PCV valve is clogged), clean or replace the valve.

NOTICE

- If the plunger does not move (PCV valve is clogged), clean or replace the valve.
- Installation
- Installation is reverse of removal. PCV Valve installation : 1.96 - 2.94 N.m (0.2 - 0.3 kgf.m, 1.45 - 2.17 lb-ft)