

Component Procedures: Alarm Module

Table of Contents

1. Immobilizer Control Unit - Repair Procedures (Article 44708)

Component Procedures: Alarm Module

Immobilizer Control Unit - Repair Procedures (Article 44708)

- Removal
- Disconnect the negative (-) battery terminal.
- Remove the main crash pad assembly. (Refer to Body - "Main Crash Pad Assembly")
- Disconnect the connector of the immobilizer unit and then remove the immobilizer unit (A) after loosening a nut.

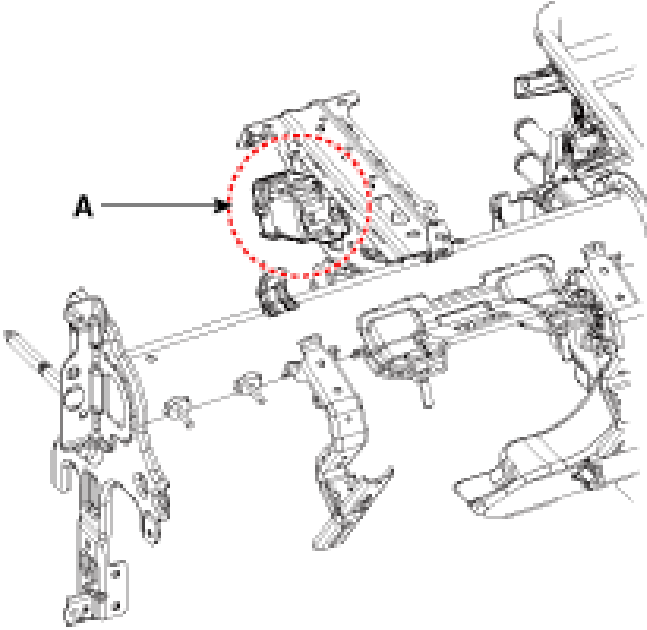

- Installation
- Install the immobilizer control unit after connecting the unit connector.
- Install the main crash pad assembly.
- Connect the negative (-) battery terminal.