

# Component Procedures: Evaporative Emissions System

## Table of Contents

1. Parts and Labor (itype\_189)
2. Evaporative Emission Control System - Description and Operation (Article 44097)
3. Evaporative Emission Control System - Schematic Diagrams (Article 44098)
4. Evaporative Emission Control System - Schematic Diagrams (Article 44101)
5. Emission Control System - Components and Components Location (Article 44092)
6. Evaporative Emission Control System - Repair Procedures (Article 44102)
7. All New Technical Service Bulletins (itype\_432)
8. All Technical Service Bulletins (itype\_100)

# Component Procedures: Evaporative Emissions System

## Parts and Labor (itype\_189)

### Parts

Qualifier	Part #	Name	Price	Note
Vapor Canister	289102E000	Purge Solenoid	33.63	
Vapor Canister	394002C300	Solenoid Valve	60.92	
Vapor Canister > Air Filter	31453F2500	Korea Built	104.69	
Vapor Canister > Air Filter	31453F3500	Us Built	107.63	
Vapor Canister > Sensor	314352J000	Fuel Tank Pressure Sen?	108.77	
Vapor Canister > Valve	31430F3500	Canister Valve	257.29	
Vapor Canister > Vapor Canis?	31420F2500	Korea Built	267.79	
Vapor Canister > Vapor Canis?	31420F3500	Us Built	543.32	

### Labor

Operation	Qualifier Path	Skill	Std Hrs	Wty Hrs
Remove & Replace	Vapor Canister > Filter, R&R	B	0.8	0.0
Remove & Replace	Vapor Canister > Purge Solenoid, R&R	B	0.4	0.0
Remove & Replace	Vapor Canister > Vapor Canister, R&R	B	0.6	0.0

## Evaporative Emission Control System - Description and Operation (Article 44097)

- Description

- Operation

Evaporative System Monitoring

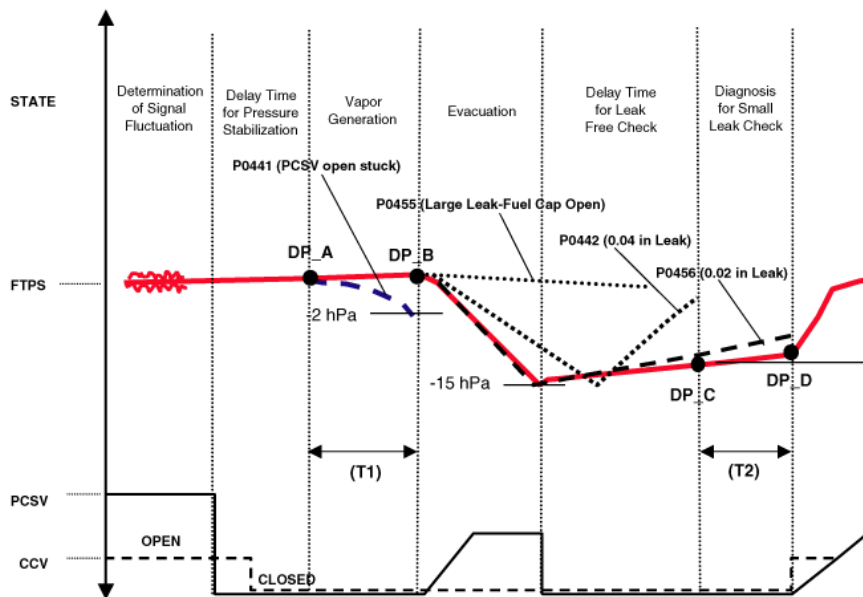

Evaporative and ORVR Emission Control System

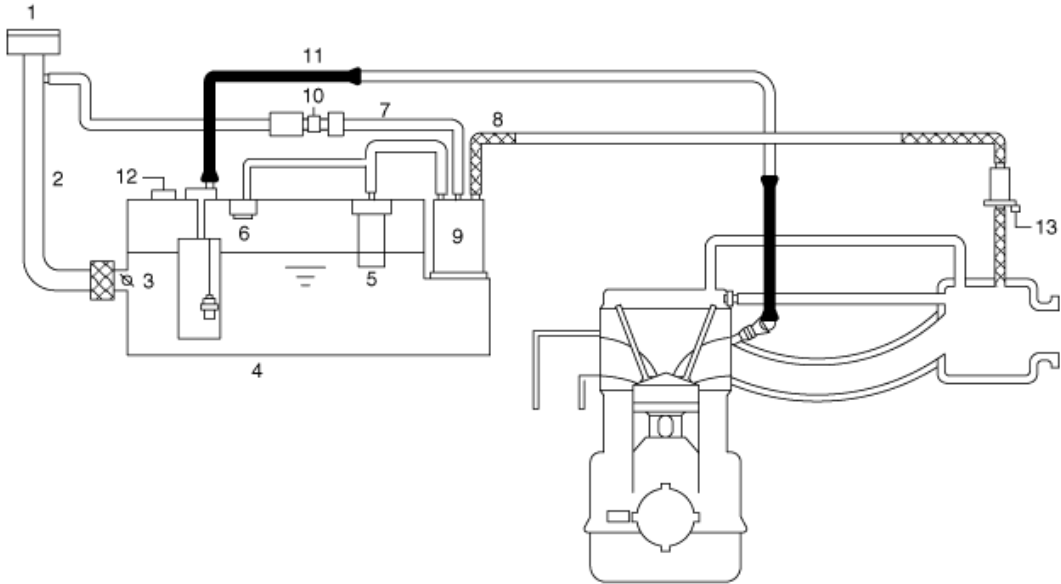

1. Fuel Filler Cap 2. Fuel Filler Pipe 3. Fuel Shut-OFF Valve 4. Fuel Tank 5. ORVR Valve 6. 2-Way & Cut Valve  
 7. Evaporative Hose 8. Evaporative Hose 9. Canister 10. Canister Close Valve ( CCV ) 11. Fuel Feed Line 12.  
 Fuel Tank Pressure Sensor (FTPS) 13. Purge Control Solenoid Valve ( PCSV )

## Evaporative Emission Control System - Schematic Diagrams (Article 44098)

- Schematic Diagram

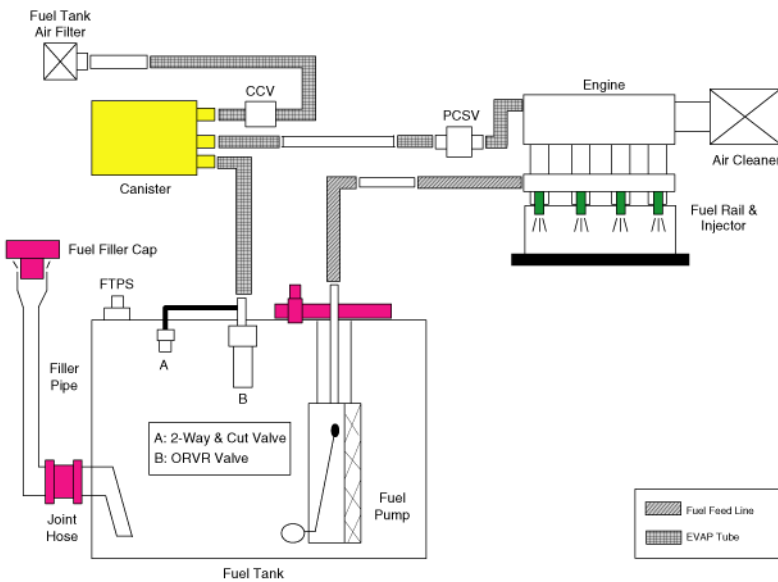

Canister  
 Purge Control Solenoid Valve ( PCSV )  
 Fuel Filler Cap  
 Fuel Tank Pressure Sensor (FTPS)  
 Canister Close Valve ( CCV )  
 Evaporative System Monitoring  
 Vapor Generation Checking  
 Large EVAP Leak Detection  
 Leaking Checking

## Evaporative Emission Control System - Schematic Diagrams (Article 44101)

- Schematic Diagram

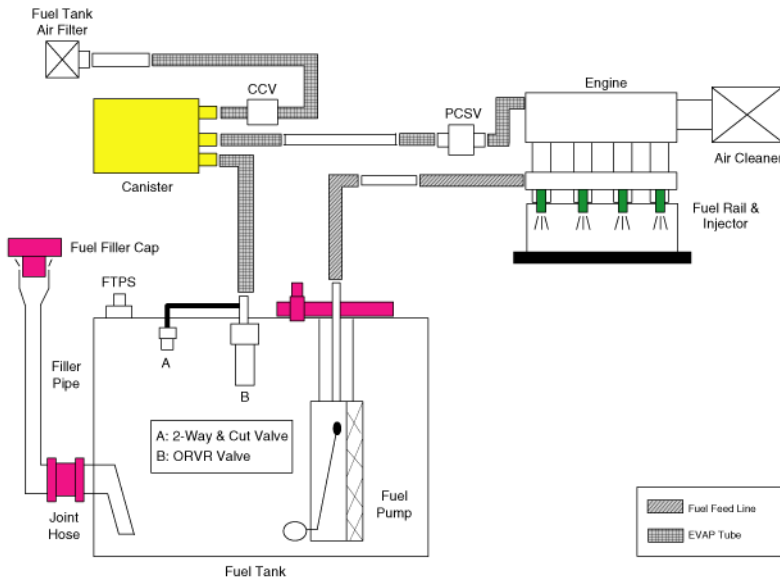

Canister

Purge Control Solenoid Valve ( PCSV )

Fuel Filler Cap

Fuel Tank Pressure Sensor (FTPS)

Canister Close Valve ( CCV )

Evaporative System Monitoring

Vapor Generation Checking

Large EVAP Leak Detection

Leaking Checking

## Emission Control System - Components and Components Location (Article 44092)

- Components Location

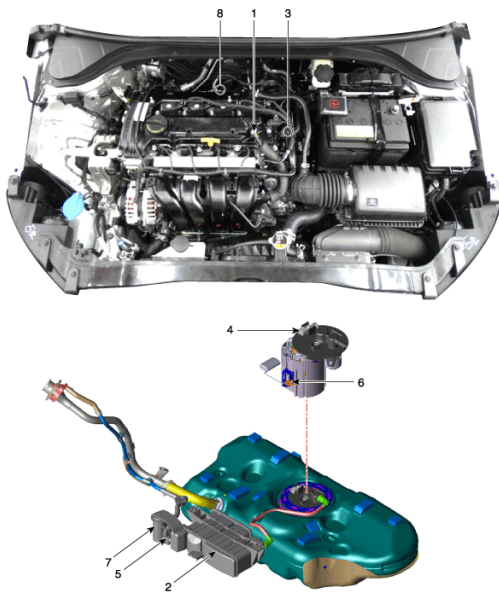

1. PCV valve
  2. Canister
  3. Purge control solenoid valve ( PCSV )
  4. Fuel tank pressure sensor (FTPS)
  5. Canister close valve ( CCV )
  6. Fuel level sensor (FLS)
  7. Fuel tank air filter
  8. Catalytic converter
1. PCV Valve 2. Canister

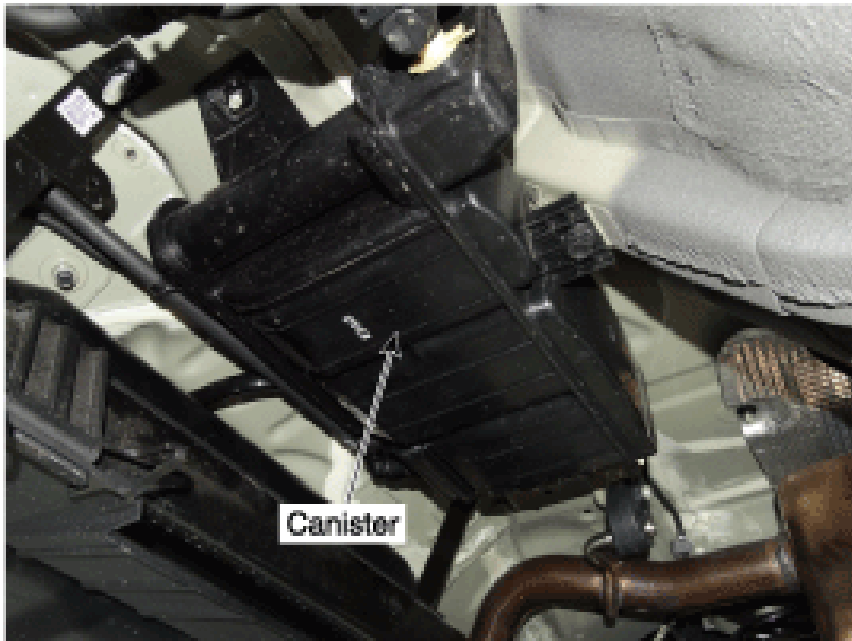
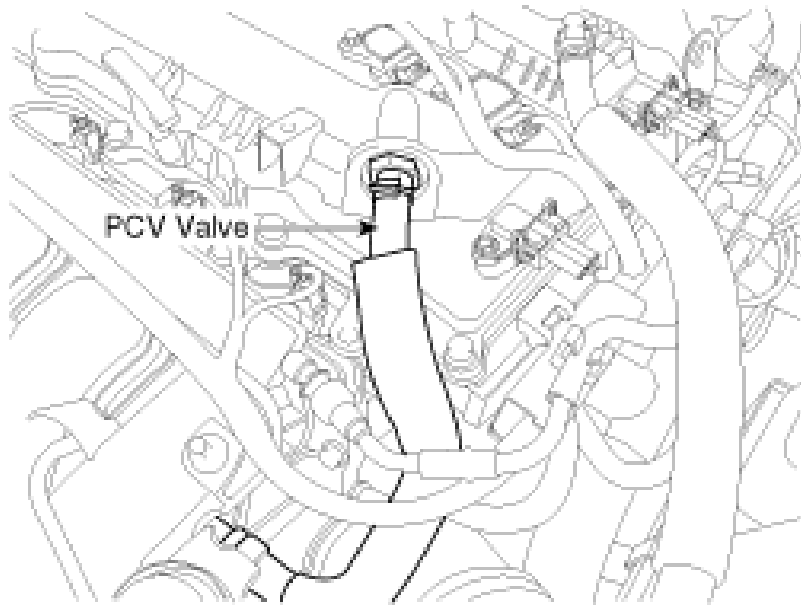

3. Purge Control Solenoid Valve (PCSV) 4. Fuel Tank Pressure Sensor (FTPS)

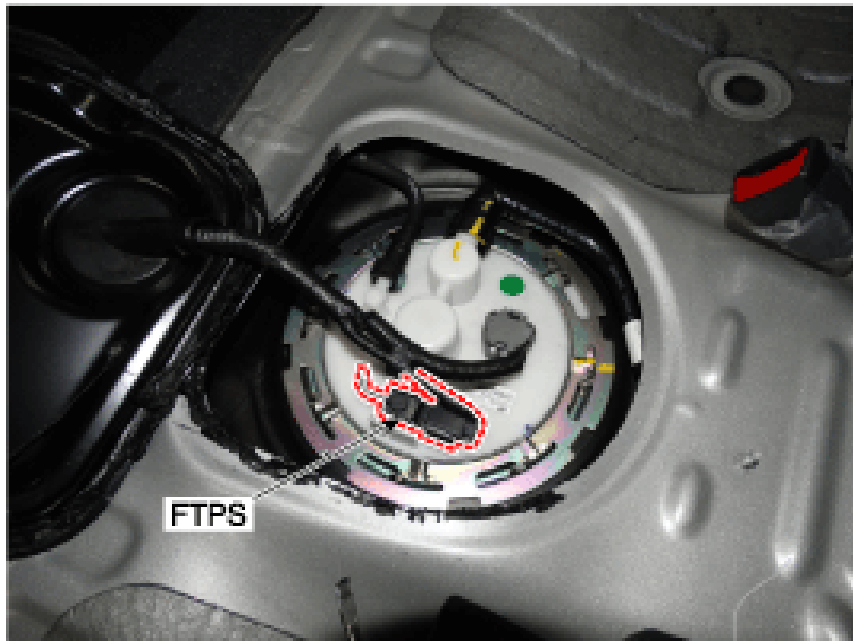
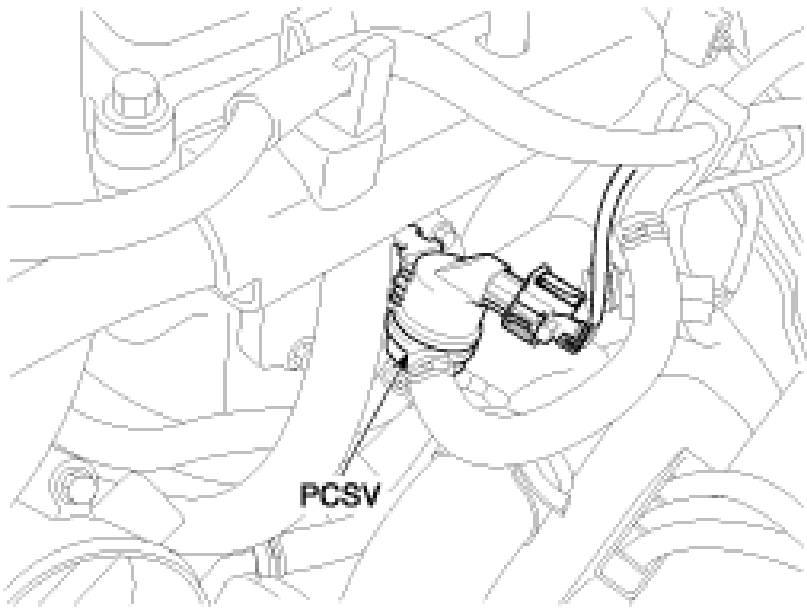

5. Canister Close Valve (CCV) 7. Fuel Tank Air Filter 6. Fuel Level Sensor (FLS)

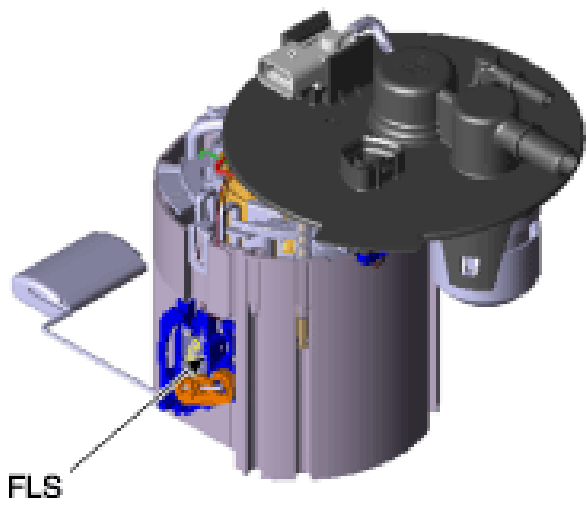
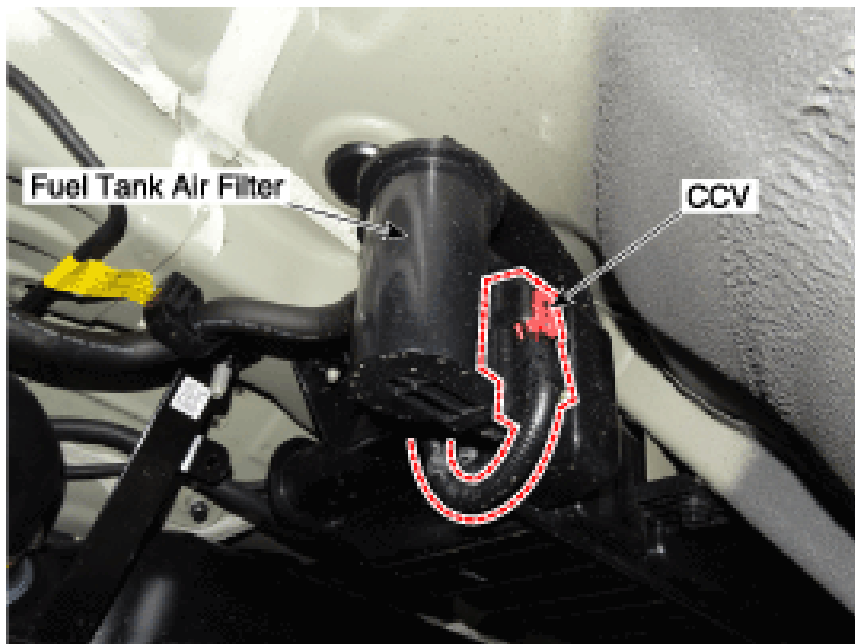

8. Catalytic Converter (WCC) 8. Catalytic Converter (UCC)

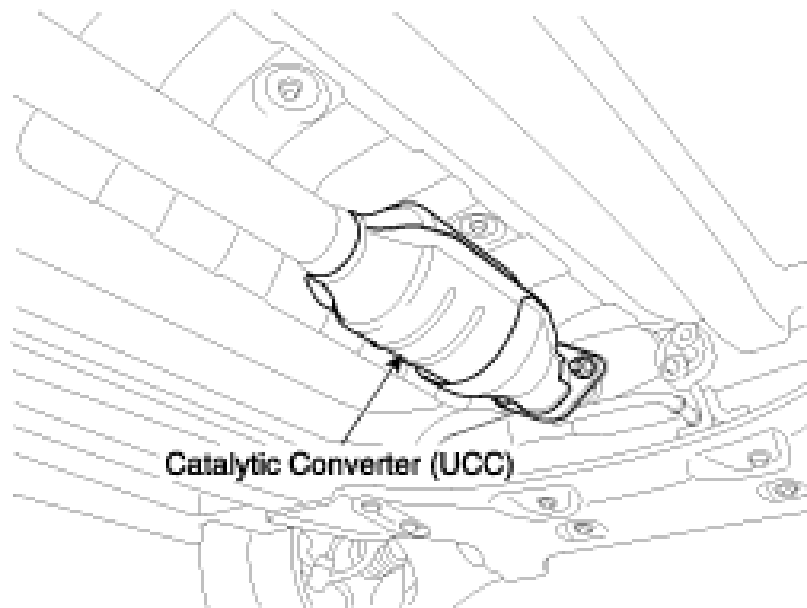
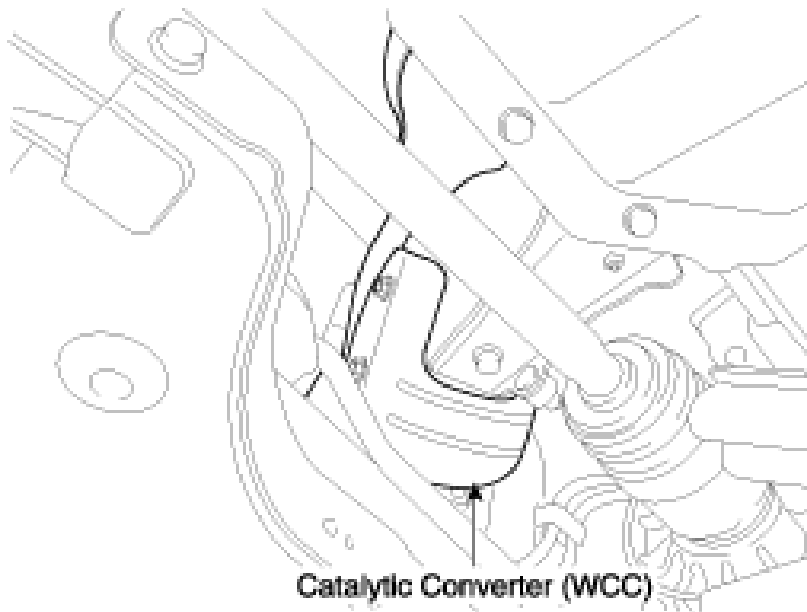

### **Evaporative Emission Control System - Repair Procedures (Article 44102)**

- Inspection
- [ EVAP . Leakage Test]
- Select "Evap. Leakage Test".

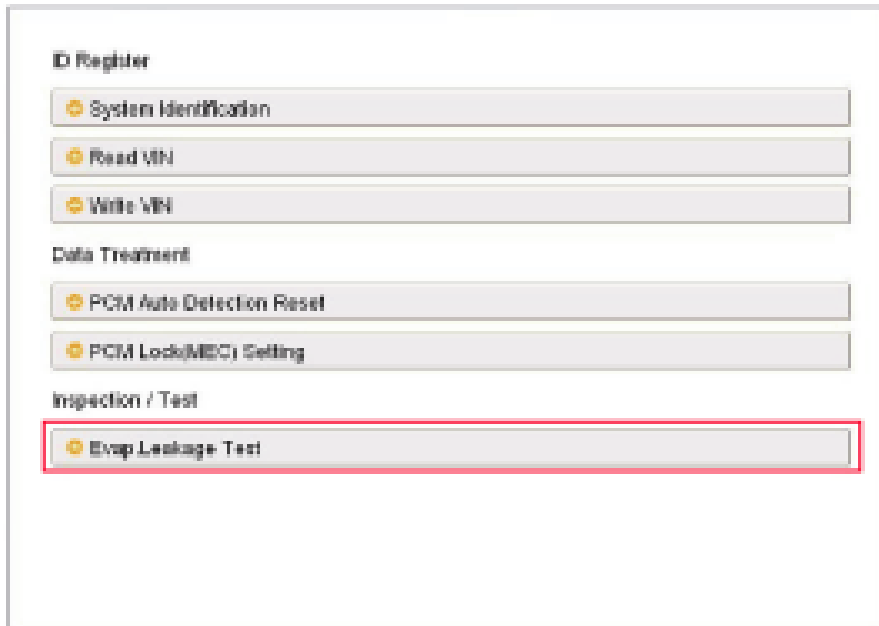

- Proceed with the test according to the screen introductions.

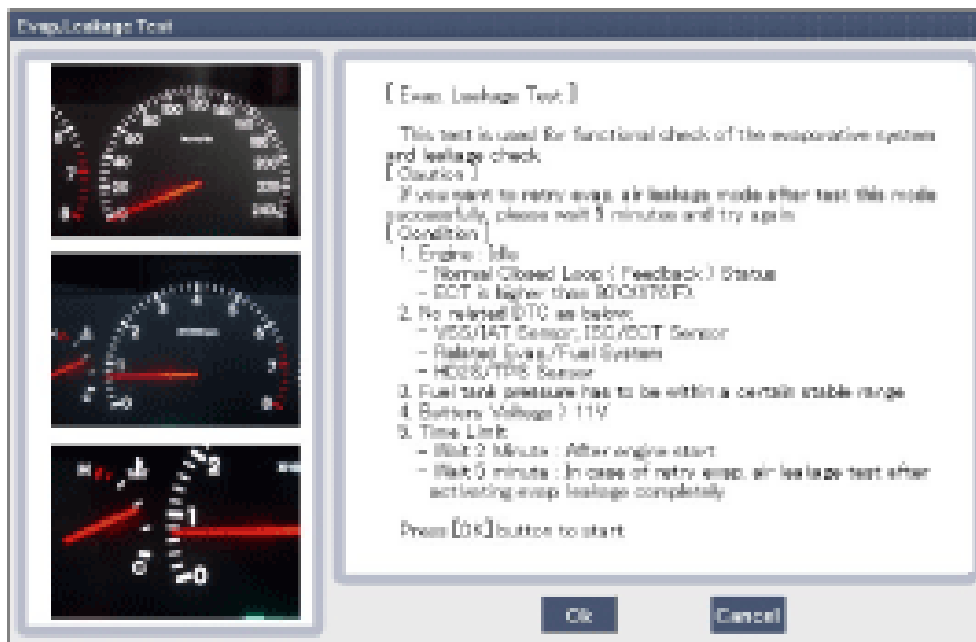

[ PCSV Inspection]

- Turn ignition switch OFF and disconnect the negative (-) battery cable.
- Disconnect the PCSV connector (A).
- Disconnect the vapor hose (B) which is connected to the intake manifold from the PCSV.

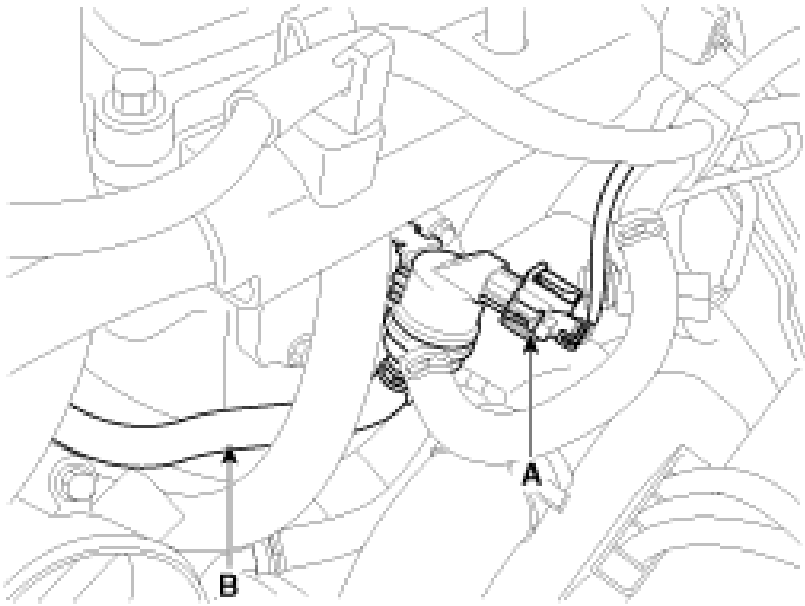

- After connecting a vacuum pump to the nipple, apply vacuum.
- With the PCSV control line grounded, check the valve operation with battery voltage applied to the PCSV(Open) and removed (Closed). Battery Voltage Valve Vacuum Connected Open Released Disconnected Close Maintained
- Battery Voltage Valve Vacuum
- Connected Open Released
- Disconnected Close Maintained
- Measure the coil resistance of the PCSV. Specifications : 22.0 - 26.0Ω [20°C (68°F)]

### **All New Technical Service Bulletins (itype\_432)**

Tsbs

- EVAP SYSTEM VACUUM/PRESSURE TESTER USAGE GUIDELINES (25-GI-019H, 2025/08/01)

### **All Technical Service Bulletins (itype\_100)**

Tsbs

- EVAP SYSTEM VACUUM/PRESSURE TESTER USAGE GUIDELINES (25-GI-019H, 2025/08/01)