

# **Component Procedures: Rear Door**

## **Table of Contents**

1. Rear Door - Components and Components Location (Article 44946)
2. Rear Door - Repair Procedures (Article 44952)
3. All Technical Service Bulletins (itype\_100)

## Component Procedures: Rear Door

### Rear Door - Components and Components Location (Article 44946)

- Components

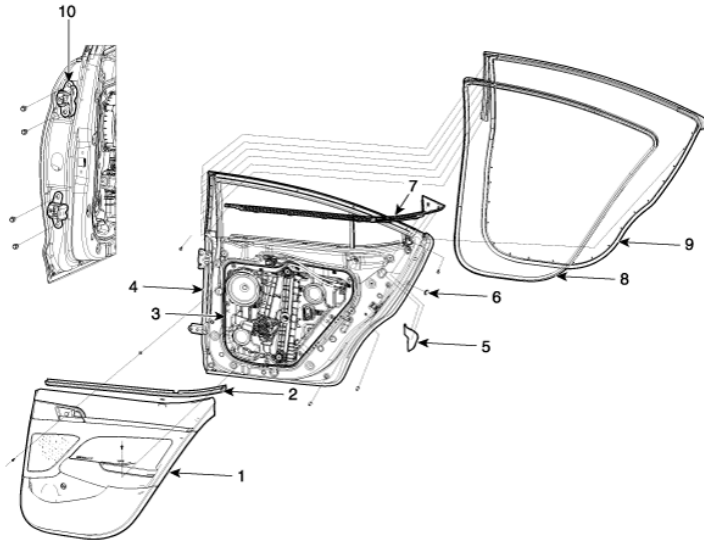

1. Rear door trim 2. Rear door belt inside weatherstrip 3. Rear door module 4. Rear door panel 5. Rear door delta inner cover 6. Holl plue 7. Rear door belt outside weatherstrip 8. Rear door body side weatherstrip 9. Rear door side weatherstrip 10. Rear door hinge

### Rear Door - Repair Procedures (Article 44952)

- Adjustment

Glass Adjustment

Check the glass run channel for damage or deterioration, and replace them if necessary.



# Information

- Check the glass run channel for damage or deterioration, and replace them if necessary.
- Remove the rear door trim.
- Separate the mounting plug hole (A) from the rear door module .

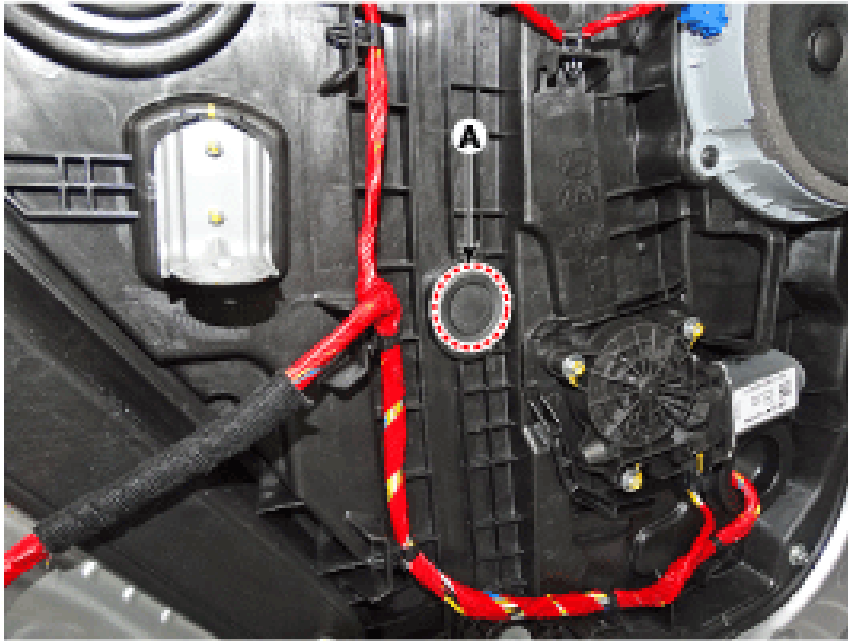

- After loosening the glass mounting bolts, adjust the spacing of the glass (A) by moving the glass from side to side and then tighten the bolts.

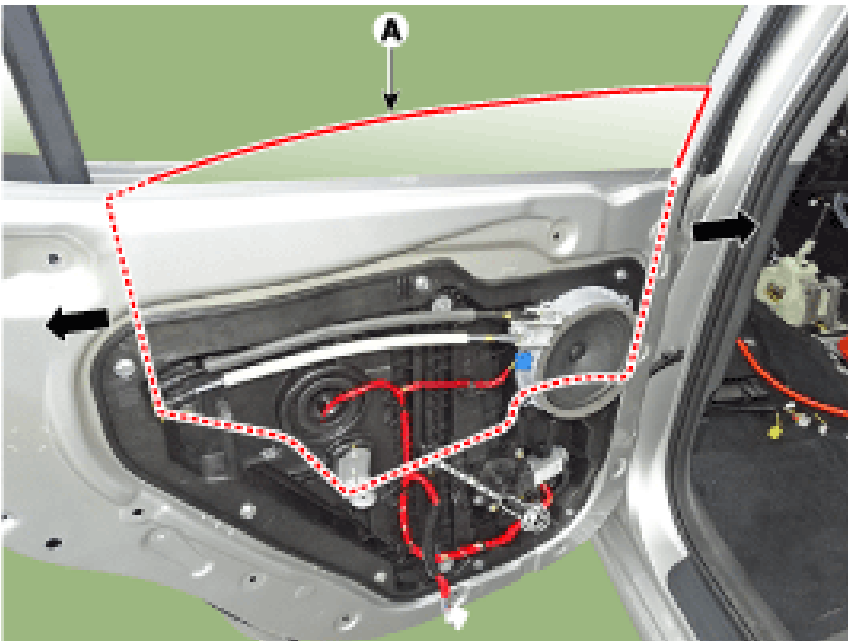

- Check the glass for normal operation.

#### Door Striker Adjustment

Make sure the door latches securely without slamming it. If necessary adjust the striker (A): The striker nuts are fixed. The striker can be fine adjusted up or down, and in or out.

- Make sure the door latches securely without slamming it. If necessary adjust the striker (A): The striker nuts are fixed. The striker can be fine adjusted up or down, and in or out.

- After loosening the mounting screw, adjust the striker (A) by moving it forward and backward or from side to side and then tighten the bolts (B). Tightening torque : (B) : 18.6 - 21.6 N.m (1.9 - 2.9 kgf.m, 13.7 - 21.0 lb-ft)

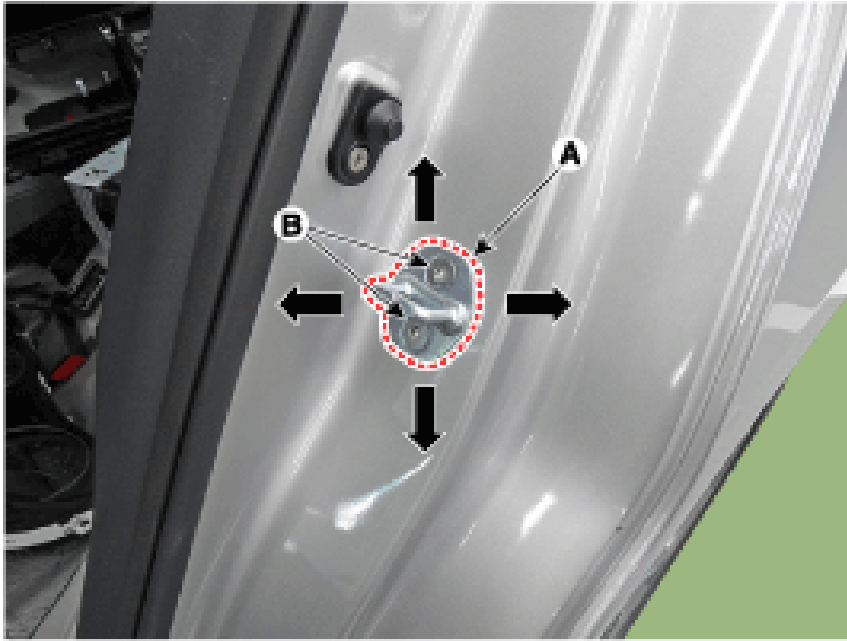

- Tap on the striker with a plastic hammer to adjust the striker. The striker will not move much, but will give some adjustment.
- Hold the outer handle out, and push the door against the body to make sure that the striker fits flush with the body. If the door latches properly, tighten the screws and recheck.

#### Door Position Adjustment

After installing the rear door, check that the body fits flush with/parallel to all the edges of front door .

Check that the door and body edges are parallel. Before adjusting, replace the mounting bolts.

- After installing the rear door, check that the body fits flush with/parallel to all the edges of front door .

. Check that the door and body edges are parallel. Before adjusting, replace the mounting bolts.

- Check that the door and body edges are parallel.

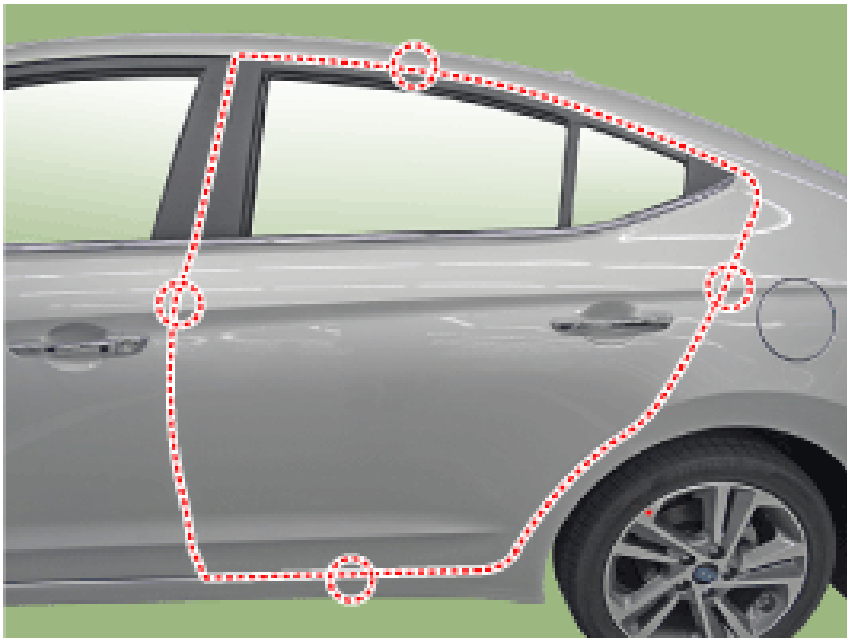

- Place the vehicle on a firm, level surface when adjusting the doors.
- Adjust the hinges (A) : Loosen the door mounting bolts slightly, and move the door in or out until it aligns flush with the body. Loosen the hinge mounting bolts slightly, and move the door backward or forward, up or down as necessary to make the gaps equal. Place a shop towel on the jack to prevent damage to the door when adjusting the door. Tightening torque : (B) : 21.6 - 26.5 N.m (2.2 - 2.7 kgf.m, 15.9 - 19.5 lb-ft) (C) : 37.3 - 41.2 N.m (3.8 - 4.2 kgf.m, 27.5 - 30.4 lb-ft)
- Loosen the door mounting bolts slightly, and move the door in or out until it aligns flush with the body.
- Loosen the hinge mounting bolts slightly, and move the door backward or forward, up or down as necessary to

make the gaps equal.

- Place a shop towel on the jack to prevent damage to the door when adjusting the door.



- Grease the pivot portions of the hinges indicated by the arrows.
- Check for water leaks.

### All Technical Service Bulletins (itype\_100)

Tsbs

- DOOR TRIM PANEL INSPECTION AND SERVICE GUIDE (23-BD-005H, 2023/03/13)