

# **Component Procedures: Seat Belt Retractor**

## **Table of Contents**

1. Rear Center Seat Belt Retractor - Components and Components Location (Article 45103)
2. Rear Seat Belt Retractor - Components and Components Location (Article 45101)
3. Rear Center Seat Belt Retractor - Repair Procedures (Article 45104)
4. Rear Seat Belt Retractor - Repair Procedures (Article 45102)

## Component Procedures: Seat Belt Retractor

### Rear Center Seat Belt Retractor - Components and Components Location (Article 45103)

- Component Location

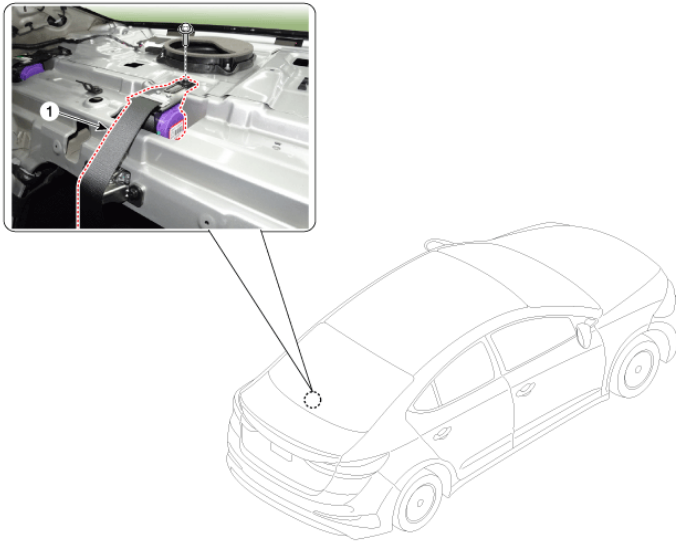

1. Rear center seat belt retractor

### Rear Seat Belt Retractor - Components and Components Location (Article 45101)

- Component Location

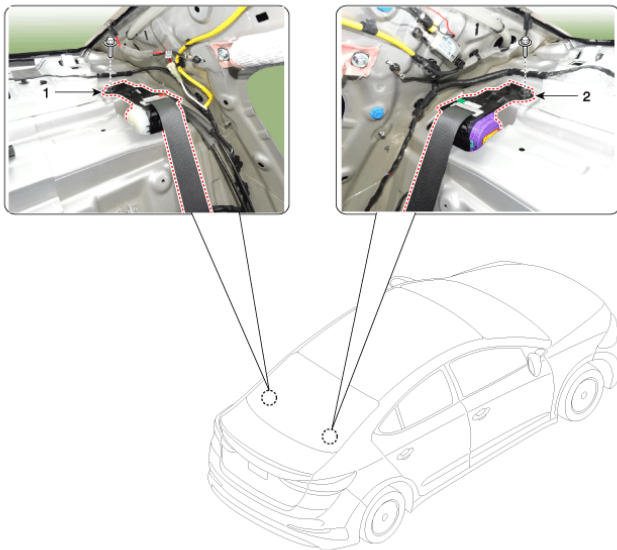

1. Rear seat belt retractor [LH] 2. Rear seat belt retractor [RH]

### Rear Center Seat Belt Retractor - Repair Procedures (Article 45104)

- Replacement

When installing the belt, make sure not to damage the retractor .

# ⚠ CAUTION

- When installing the belt, make sure not to damage the retractor .
- Remove the package tray trim. (Refer to Interior Trim - "Rear Package Tray Trim")
- After loosening the mounting bolts, remove the rear center seat belt retractor (A). Tightening torque : 39.2
- 53.9 N.m (4.0 - 5.5 kgf.m, 28.8 - 39.8 lb-ft)

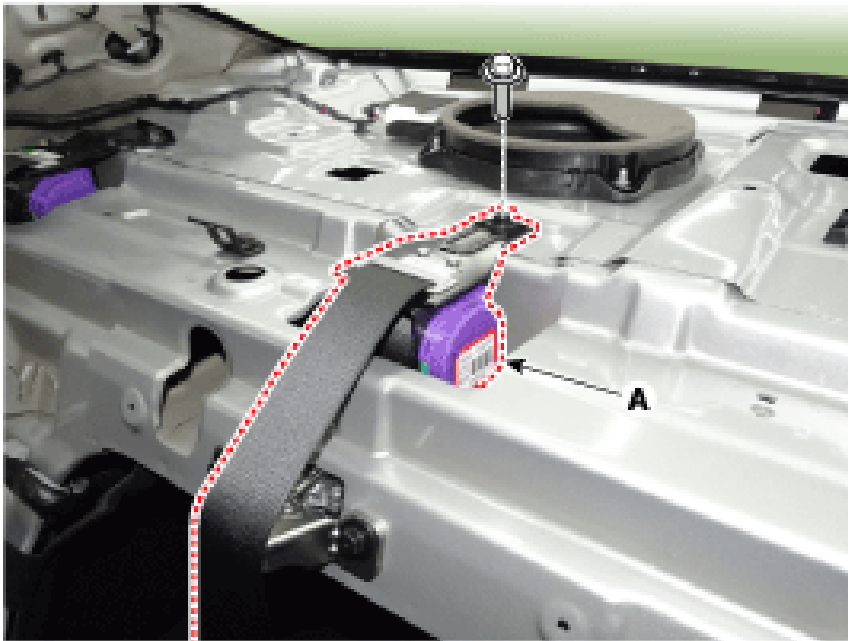

- To install, reverse the removal procedure. Replace any damaged clips.
- Replace any damaged clips.



## Information

- Replace any damaged clips.

### **Rear Seat Belt Retractor - Repair Procedures (Article 45102)**

- Replacement

When installing the belt, make sure not to damage the retractor .

# NOTICE

- When installing the belt, make sure not to damage the retractor .
- Remove the package tray trim. (Refer to Interior Trim - "Package Tray Trim")
- After loosening the mounting bolt, remove the rear seat belt lower anchor (A). Tightening torque : 39.2 - 53.9 N.m (4.0 - 5.5 kgf.m, 28.8 - 39.8 lb-ft)

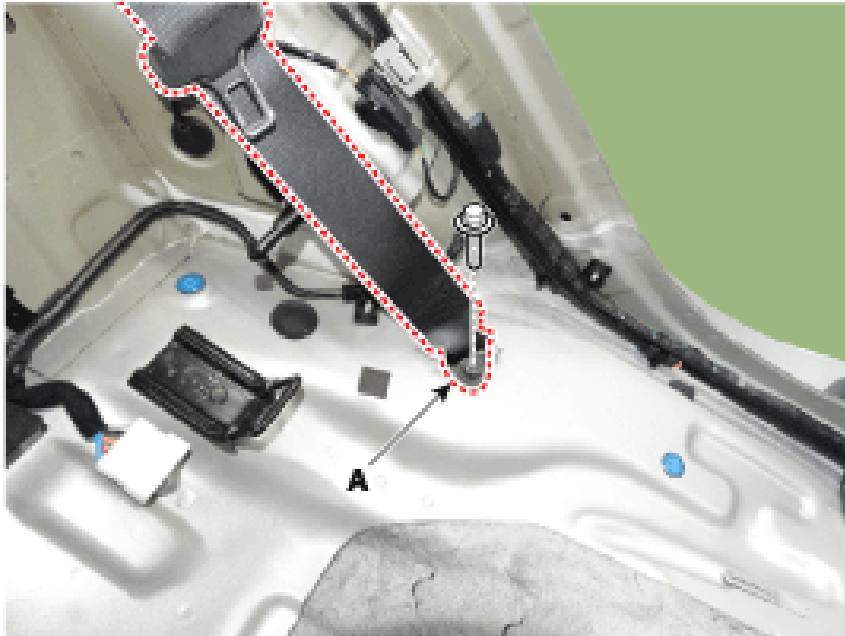

- Loosen the retractor (A) mounting bolt, remove the rear seat belt (B). Tightening torque : 39.2 - 53.9 N.m (4.0 - 5.5 kgf.m, 28.8 - 39.8 lb-ft) [LH] [RH]

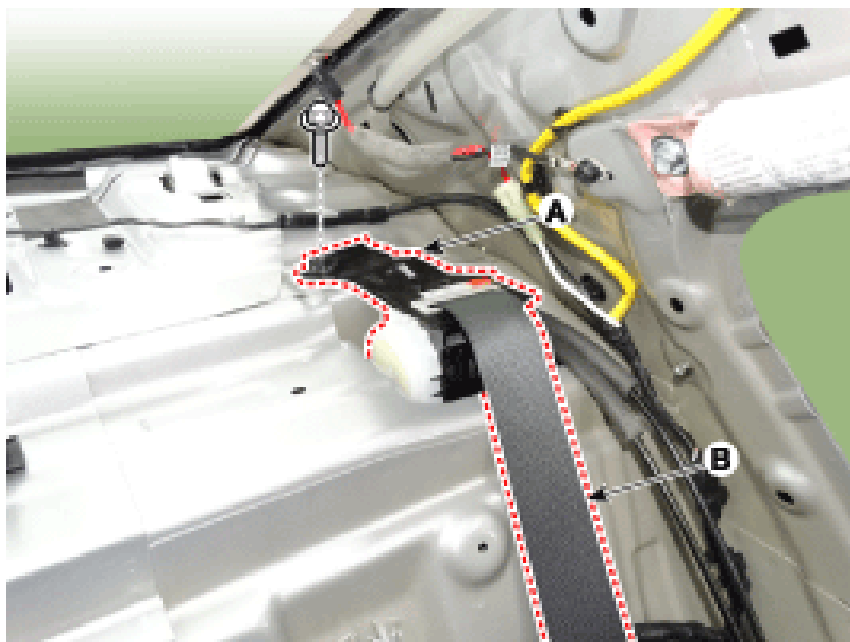

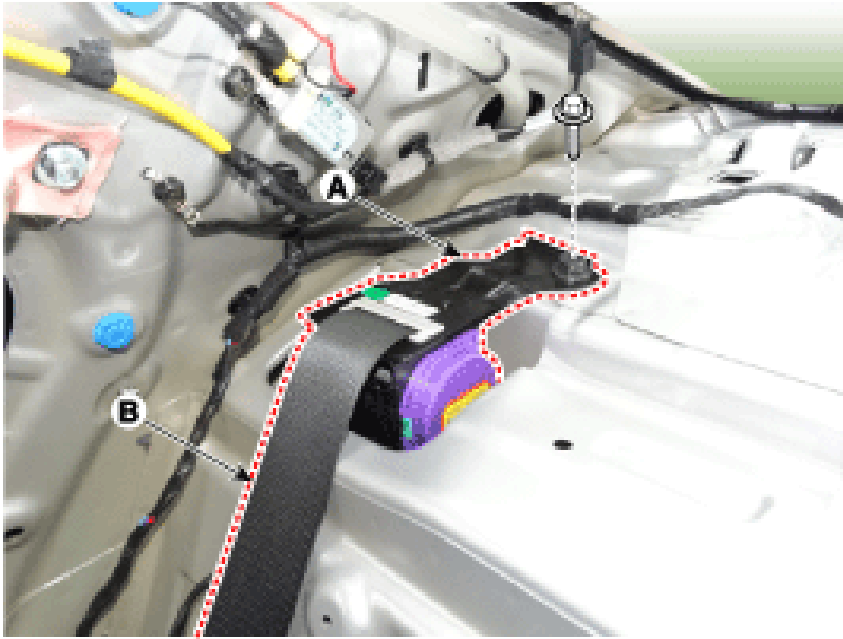

- To install, reverse the removal procedure. Replace any damaged clips (or pin-type retainers).  
Replace any damaged clips (or pin-type retainers).

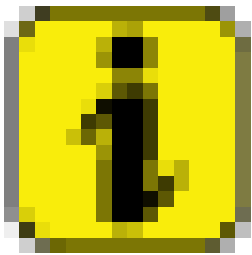

# Information

- Replace any damaged clips (or pin-type retainers).