

Component Procedures: Front Door

Table of Contents

1. Front Door - Components and Components Location (Article 45136)
2. Front Door - Repair Procedures (Article 45140)
3. All Technical Service Bulletins (itype_100)

Component Procedures: Front Door

Front Door - Components and Components Location (Article 45136)

- Components

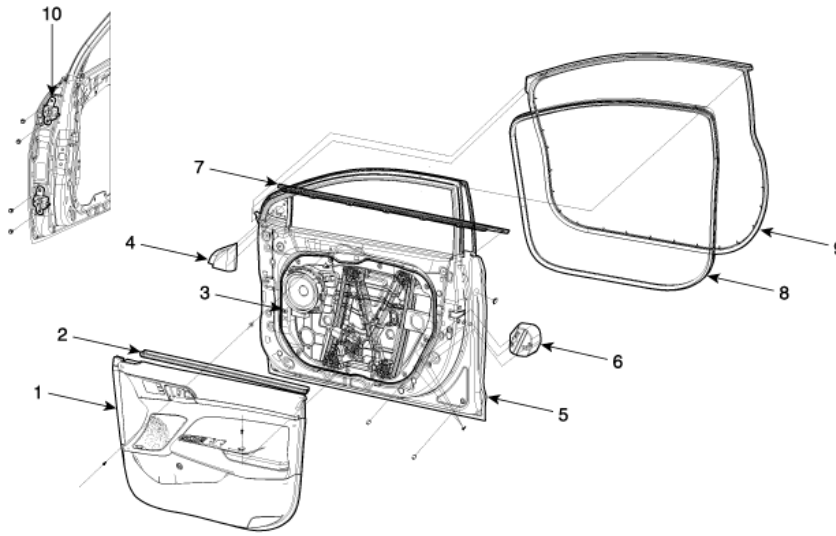

1. Front door trim 2. Front door belt inside weatherstrip 3. Front door module 4. Front door quadrant inner cover 5. Front door panel 6. Front door side impact pad 7. Front door belt outside weatherstrip 8. Front door body side weatherstrip 9. Front door side weatherstrip 10. Front door hinge

Front Door - Repair Procedures (Article 45140)

- Adjustment

Glass Adjustment

Check the glass run channel for damage or deterioration, and replace it if necessary.



Information

- Check the glass run channel for damage or deterioration, and replace it if necessary.
- Remove the front door trim . (Refer to Front Door - "Front Door Trim")
- Separate the mounting plug hole (A) from the front door module.

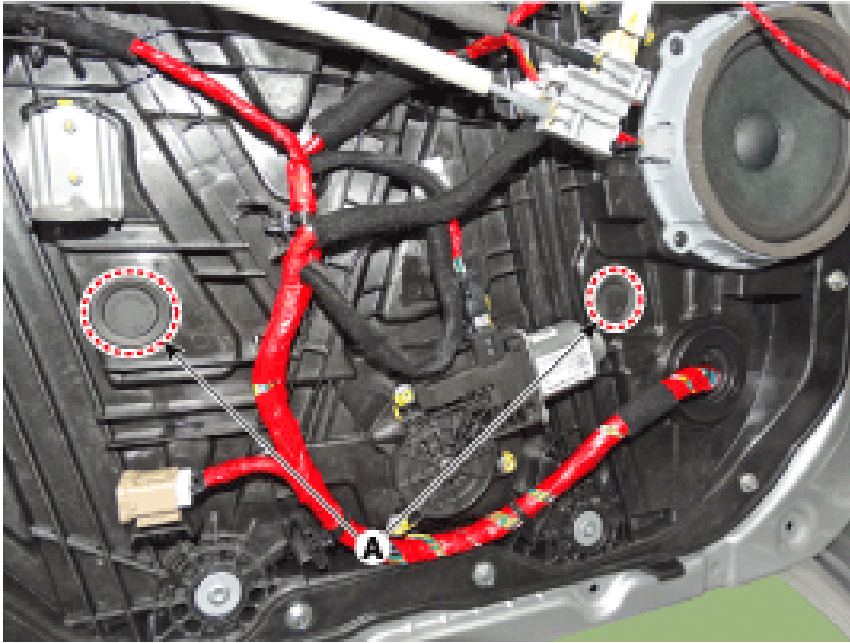

- After loosening the glass mounting bolts, adjust the spacing of the glass (A) by moving the glass from side to side and then tighten the bolts.

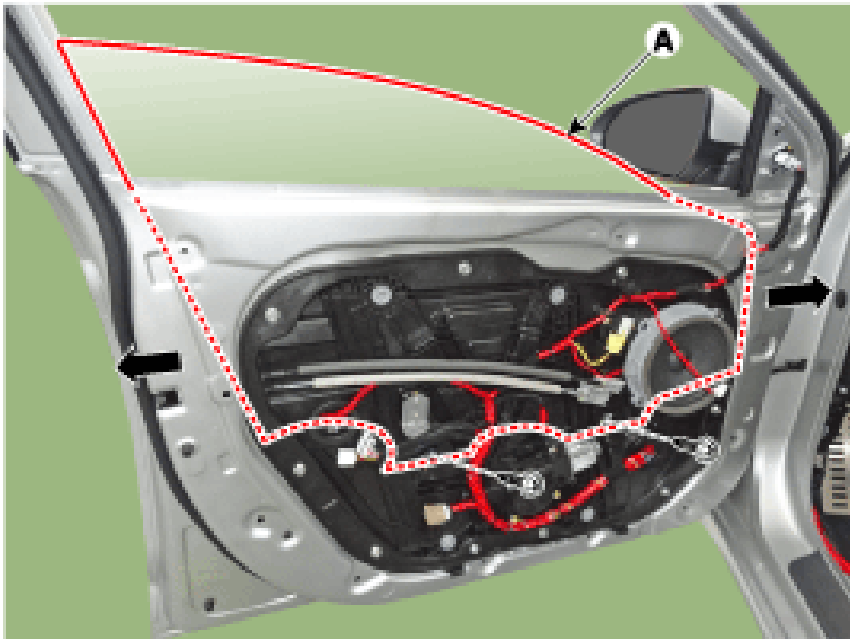

- Check the glass for normal operation.

Door Striker Adjustment

Make sure the door latches securely without slamming it. If necessary adjust the striker (A): The striker nuts are fixed. The striker can be fine adjusted up or down, and in or out.

- Make sure the door latches securely without slamming it. If necessary adjust the striker (A): The striker nuts are fixed. The striker can be fine adjusted up or down, and in or out.

- After loosening the mounting screw, adjust the striker (A) by moving it forward and backward or from side to side and then tighten the bolts (B). Tightening torque : (B) : 18.6 - 28.4 N.m (1.9 - 2.9 kgf.m, 13.7 - 21.0 lb-ft)

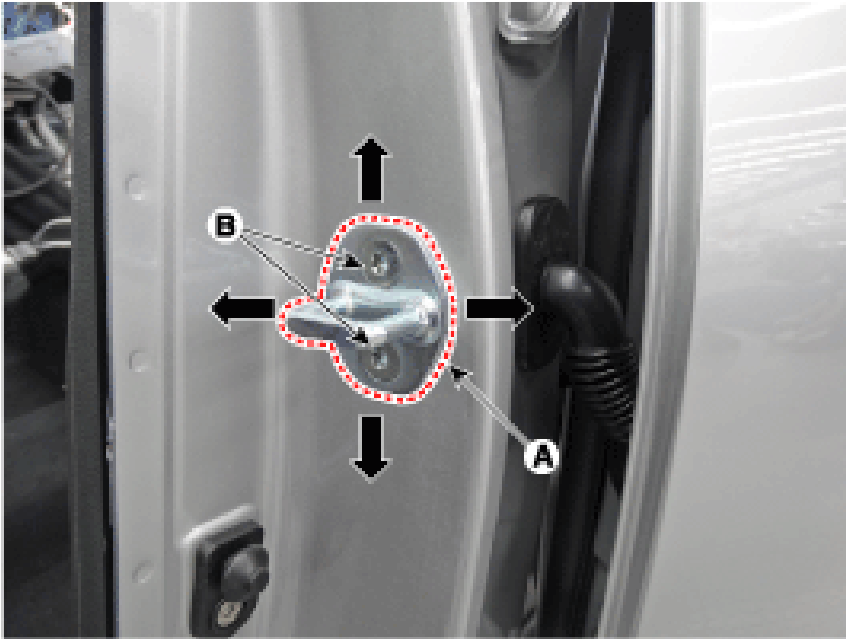

- Tap on the striker with a plastic hammer to adjust the striker. The striker will not move much, but will give some adjustment.
- Hold the outer handle out, and push the door against the body to be sure the striker allows a flush fit. If the door latches properly, tighten the screws and recheck.

Door Position Adjustment

After installing the door, check that the body fits flush with/parallel to all the edges of front door. Check that the door and body edges are parallel. Before adjusting, replace the mounting bolts.

- After installing the door, check that the body fits flush with/parallel to all the edges of front door. Check that the door and body edges are parallel. Before adjusting, replace the mounting bolts.
- Check that the door and body edges are parallel.

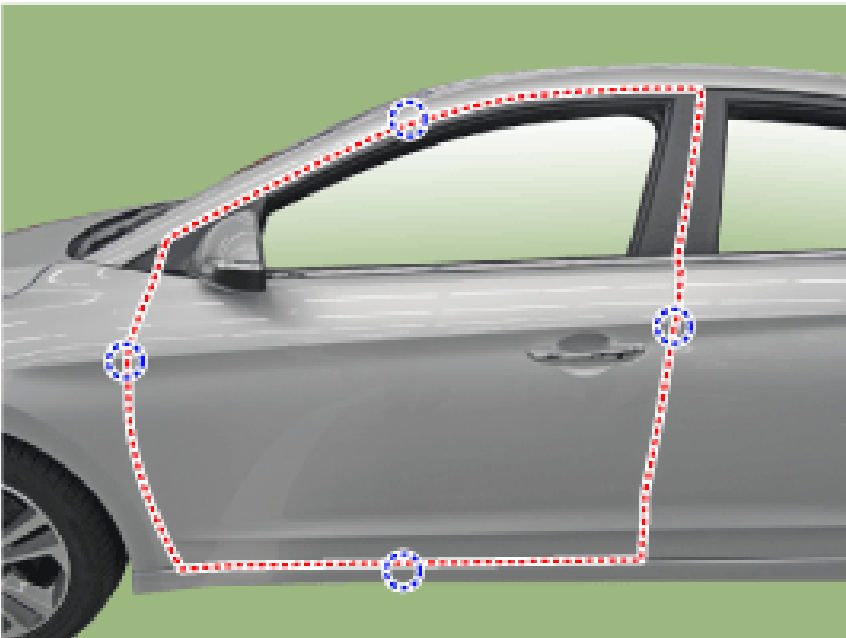

- Place the vehicle on a level surface before adjusting the doors.
- Adjust the hinges (A) : Loosen the door mounting bolts slightly, and move the door in or out until it flush with the body. Loosen the hinge mounting bolts slightly, and move the door backward or forward, up or down as necessary. Place a shop towel on the jack to prevent damage to the door when adjusting the door. Tightening torque : (B) : 21.6 - 26.5 N.m (2.2 - 2.7 kgf.m, 15.9 - 19.5 lb-ft) (C) : 37.3 - 41.2 N.m (3.8 - 4.2 kgf.m, 27.5 - 30.4 lb-ft)
- Loosen the door mounting bolts slightly, and move the door in or out until it flush with the body.
- Loosen the hinge mounting bolts slightly, and move the door backward or forward, up or down as necessary.

- Place a shop towel on the jack to prevent damage to the door when adjusting the door.

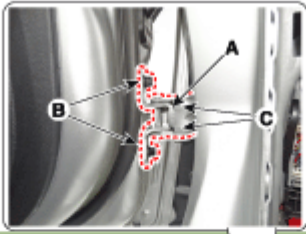

- Grease the pivot portions of the hinges indicated.
- Check for water leaks.

All Technical Service Bulletins (itype_100)

Tsbs

- DOOR TRIM PANEL INSPECTION AND SERVICE GUIDE (23-BD-005H, 2023/03/13)