

Component Procedures: Brake Pedal Assy

Table of Contents

1. Brake Pedal - Components and Components Location (Article 45175)
2. Stop Lamp Switch - Components and Components Location (Article 45159)
3. Brake Pedal - Repair Procedures (Article 45176)

Component Procedures: Brake Pedal Assy

Brake Pedal - Components and Components Location (Article 45175)

- Components

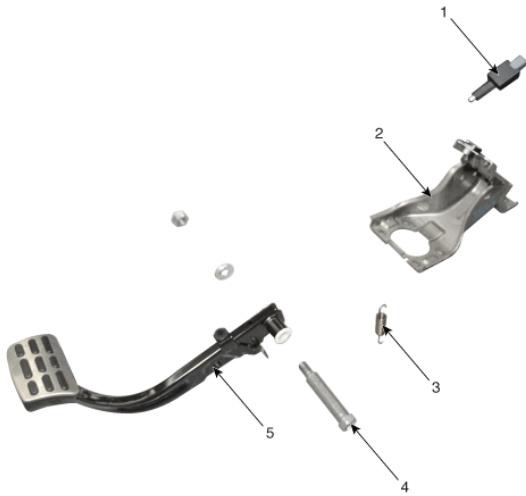

1. Stop lamp switch 2. Brake pedal member assembly 3. Return spring 4. Bolt 5. Brake pedal arm assembly

Stop Lamp Switch - Components and Components Location (Article 45159)

- Components

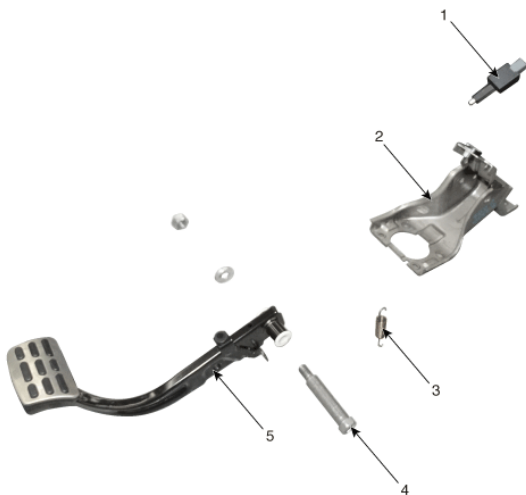

1. Stop lamp switch 2. Brake pedal member assembly 3. Return spring 4. Bolt 5. Brake pedal arm assembly

Brake Pedal - Repair Procedures (Article 45176)

- Removal
- Turn ignition switch OFF and disconnect the negative (-) battery cable.
- Remove the crash pad lower panel. (Refer to Body - "Crash Pad")
- Disconnect the stop lamp switch connector (A).

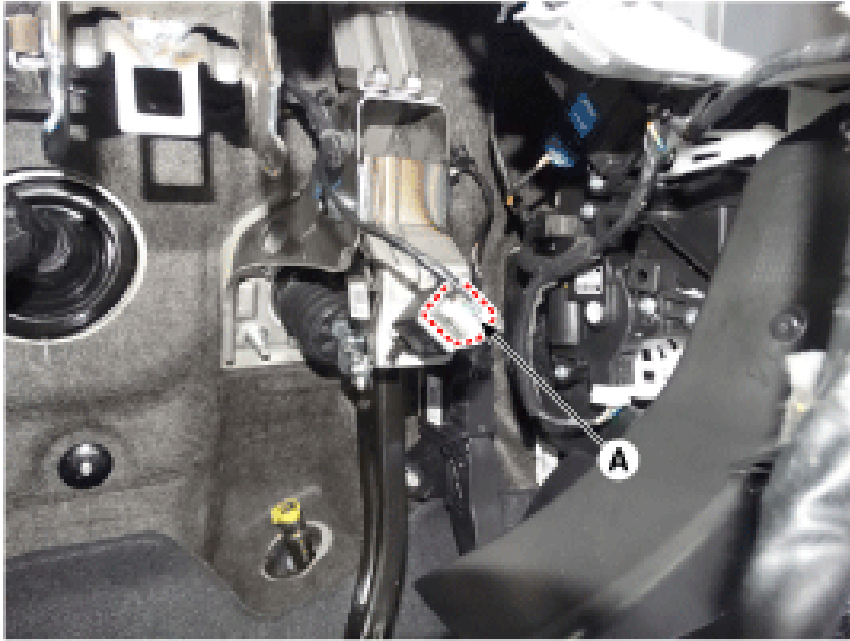

- Remove the wiring fixed clip from the brake pedal member.

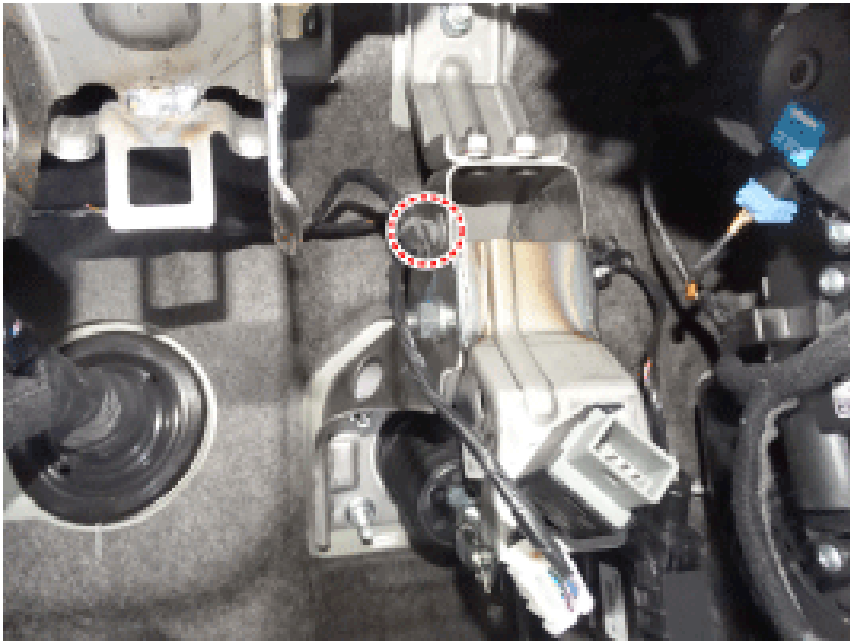

- Remove the bracket mounting nut (A). Tightening torque : 16.7 - 25.5 N.m (1.7 - 2.6 kgf.m, 12.3 - 18.8 lb-ft)

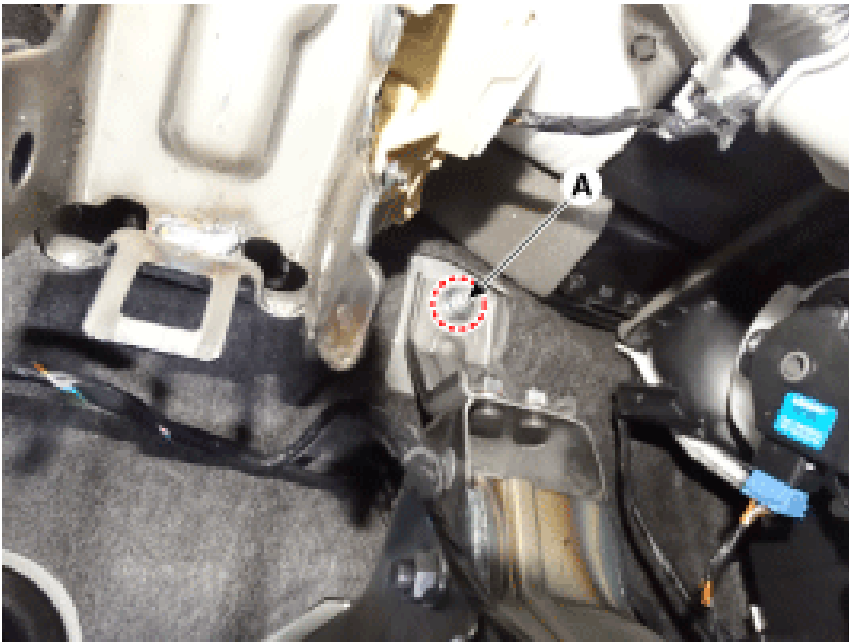

- Remove the snap pin (A) and clevis pin (B).

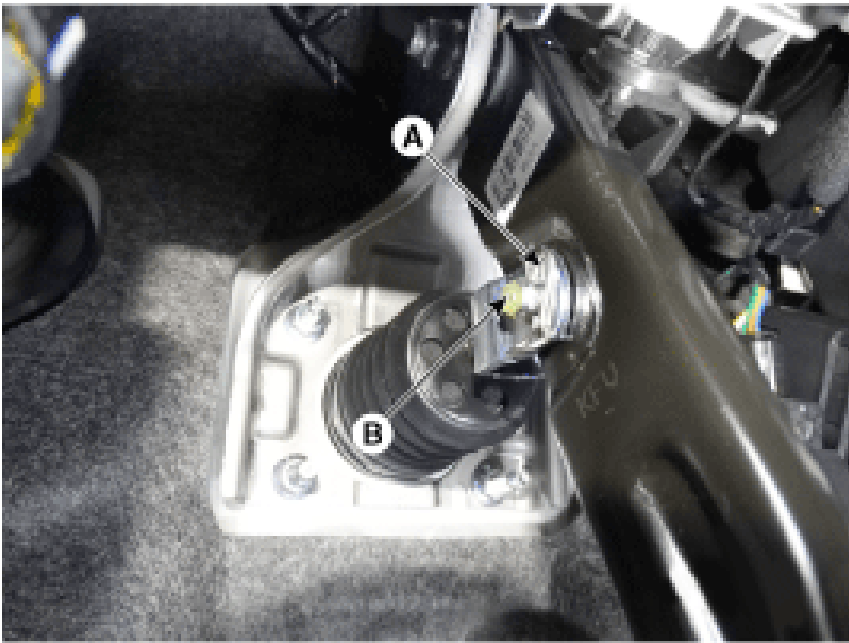

- Remove the mounting nuts (A). Tightening torque : 16.7 - 25.5 N.m (1.7 - 2.6 kgf.m, 12.3 - 18.8 lb-ft)

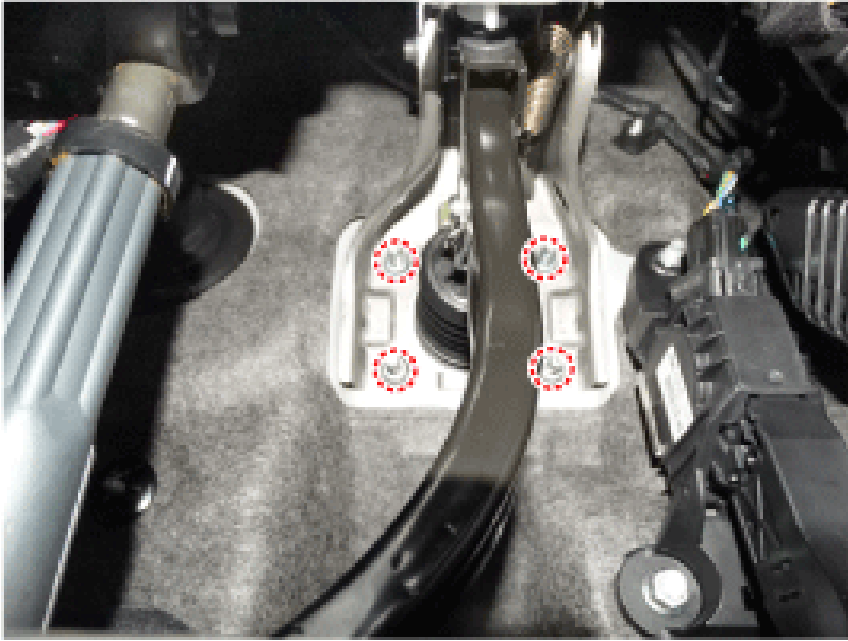

- To install, reverse the removal procedure.
- Inspection
- Check the brake pedal for bending or twisting.
- Check the brake pedal return spring for damage.
- Check the stop lamp switch.