

Component Procedures: Rear Crankshaft Main Bearing Seal

Table of Contents

1. Parts and Labor (itype_189)
2. Rear Oil Seal - Components and Components Location (Article 45352)
3. Rear Oil Seal - Repair Procedures (Article 45353)

Component Procedures: Rear Crankshaft Main Bearing Seal

Parts and Labor (itype_189)

Parts

Qualifier	Part #	Name	Price	Note
Crankshaft & Bearings > Rear?	214432E110	28 - Rear Main Seal	35.58	

Labor

Operation	Qualifier Path	Skill	Std Hrs	Wty Hrs
Remove & Replace	Crankshaft & Bearings > Rear Main Seal, R&R	B	0.5	0.0

Rear Oil Seal - Components and Components Location (Article 45352)

- Components

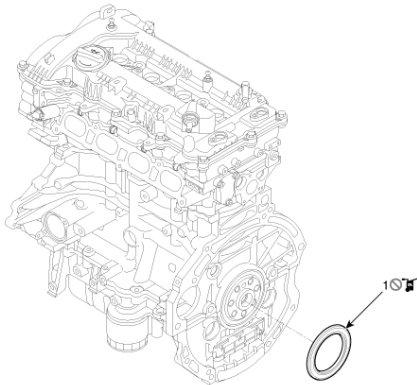

Tightening torque : N.m (kgf.m, lb-ft)

1. Rear oil seal

Rear Oil Seal - Repair Procedures (Article 45353)

- Removal
- Remove the automatic transaxle. (Refer to Automatic Transaxle System - "Automatic Transaxle")
- Remove the drive plate. (Refer to Cylinder Block – "Drive Plate")
- Remove the rear oil seal (A).

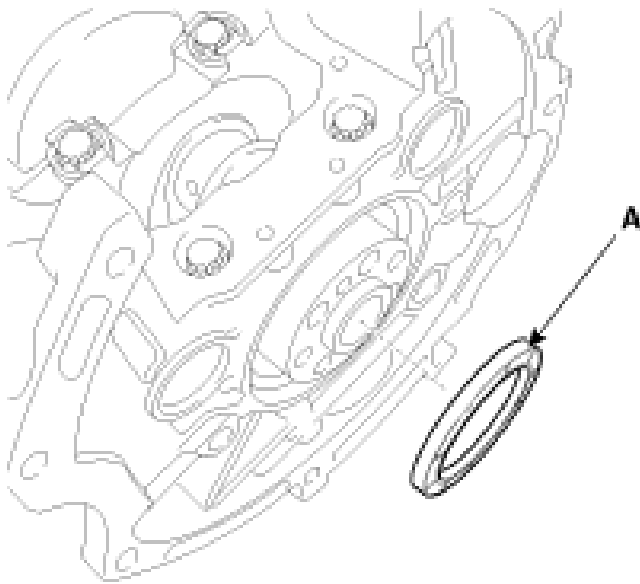

- Installation

- Install a new rear oil seal. Apply engine oil on the edge of new oil seal. Using SST (09231-H1100, 09214-2E000) and a hammer, tap in the oil seal (A) until the SST face is aligned with the cylinder block assembly rear face.

- Apply engine oil on the edge of new oil seal.

- Using SST (09231-H1100, 09214-2E000) and a hammer, tap in the oil seal (A) until the SST face is aligned with the cylinder block assembly rear face.

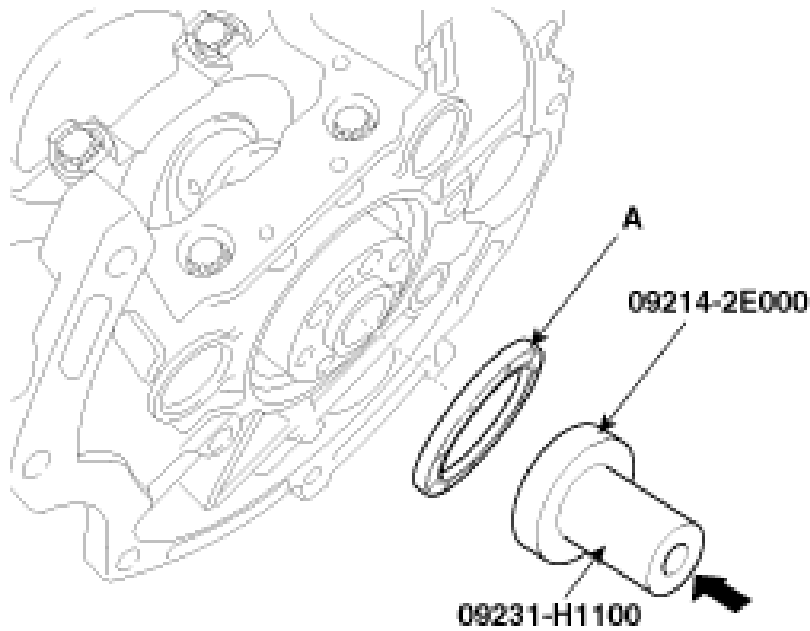

- Install the other parts reverse order of removal.